



CONTRACT NO: HK/2011/07

WANCHAI DEVELOPMENT PHASE II AND CENTRAL
WANCHAI BYPASS
SAMPLING, FIELD MEASUREMENT AND TESTING WORK
(STAGE 2)

ENVIRONMENTAL PERMIT NO. EP-122/2002/D
MONTHLY ENVIRONMENTAL MONITORING & AUDIT REPORT
- AUGUST 2014 -

CLIENTS:

Civil Engineering and Development
Department

PREPARED BY:

Lam Geotechnics Limited

11/F Centre Point
181-185 Gloucester Road,
Wanchai, H.K.

Telephone: (852) 2882-3939
Facsimile: (852) 2882-3331
E-mail: info@lamenviro.com
Website: <http://www.lamenviro.com>

CERTIFIED BY:

Raymond Dai
Environmental Team Leader

DATE:

10 September 2014

Ref.: AACWBIECEM00_0_5665L.14

10 September 2014

AECOM Asia Company Limited
11/F, Tower 2
Grand Central Plaza
138 Shatin Rural Committee Road
Shatin, New Territories
Hong Kong

By Post and Fax (2691 2649)

Attention: Mr. Conrad Ng

Dear Sir,

Re: Wan Chai Development Phase II and Central-Wan Chai Bypass
Monthly Environmental Monitoring and Audit Report (August 2014) for EP-122/2002/D

Reference is made to the Environmental Team's submission of the captioned Monthly Environmental Monitoring and Audit (EM&A) Report for August 2014 received by e-mail on 10 September 2014.

Please be informed that we have no adverse comment on the captioned submission. We write to verify the captioned submission in accordance with Condition 4.6 in the captioned Environmental Permit.

Thank you very much for your kind attention and please do not hesitate to contact the undersigned should you have any queries.

Yours sincerely,



David Yeung
Independent Environmental Checker

c.c.	CEDD	Mr. Jason Cheung	by fax: 2577 5040
	AECOM	Mr. Francis Leong / Mr. Stephen Lai	by fax: 2691 2649
	Lam	Mr. Raymond Dai	by fax: 2882 3331

Q:\Projects\AACWBIECEM00\Corr\AACWBIECEM00_0_5665L.14.doc



TABLE OF CONTENTS

EXECUTIVE SUMMARY	3
1 INTRODUCTION.....	5
1.1 Scope of the Report.....	5
1.2 Structure of the Report	5
2 PROJECT BACKGROUND	7
2.1 Background	7
2.2 Scope of the Project and Site Description	7
2.3 Project Organization and Contact Personnel.....	8
3 STATUS OF REGULATORY COMPLIANCE.....	10
3.1 Status of Environmental Licensing and Permitting under the Project.....	10
4 MONITORING REQUIREMENTS	12
4.1 Noise Monitoring.....	12
4.2 Air Quality Monitoring	13
5 MONITORING RESULTS	15
5.1 Noise Monitoring Results.....	15
5.2 Air Quality Monitoring Results	16
5.3 Waste Monitoring Results.....	17
6 COMPLIANCE AUDIT	18
6.1 Noise Monitoring.....	18
6.2 Air Quality Monitoring	18
6.3 Review of the Reasons for and the Implications of Non-compliance.....	18
6.4 Summary of action taken in the event of and follow-up on non-compliance.....	18
7 CUMULATIVE CONSTRUCTION IMPACT DUE TO THE CONCURRENT PROJECTS	19
8 ENVIRONMENTAL SITE AUDIT	19
9 COMPLAINTS, NOTIFICATION OF SUMMONS AND PROSECUTION	21
10 CONCLUSION	22

LIST OF TABLES

Table 2.1	<i>Schedule 2 Designated Projects under this Project</i>
Table 2.2	<i>Contact Details of Key Personnel</i>
Table 3.1	<i>Summary of the current status on licences and/or permits on environmental protection pertinent to the Project</i>
Table 3.2	<i>Cumulative Summary of Valid Licences and Permits under Contract no. HK/2012/08</i>
Table 4.1	<i>Continuous Noise Monitoring Stations</i>
Table 4.2	<i>Air Quality Monitoring Stations</i>
Table 5.1	<i>Continuous Noise Monitoring Stations for Contract no. HK/2012/08</i>
Table 5.2	<i>Air Quality Monitoring Station for Contract no. HK/2012/08</i>
Table 5.3	<i>Details of Waste Disposal for Contract no. HK/2012/08</i>
Table 8.1	<i>Summary of Environmental Inspections for Contract no. HK/2012/08</i>
Table 9.1	<i>Cumulative Statistics on Complaints</i>
Table 9.2	<i>Cumulative Statistics on Successful Prosecutions</i>
Table 10.1	<i>Summary of Key Construction Activities of Individual Contract(s) to be commenced in Coming Reporting Month</i>

LIST OF FIGURES

<u>Figure 2.1</u>	Project Layout
<u>Figure 2.2</u>	Project Organization Chart
<u>Figure 4.1</u>	Locations of Environmental Monitoring Stations

LIST OF APPENDICES

<u>Appendix 3.1</u>	Environmental Mitigation Implementation Schedule
<u>Appendix 4.1</u>	Action and Limit Level
<u>Appendix 4.2</u>	Copies of Calibration Certificates
<u>Appendix 5.1</u>	Monitoring Schedule for Reporting Month and Coming month
<u>Appendix 5.2</u>	Continuous Noise Monitoring Results and Graphical Presentations
<u>Appendix 5.3</u>	Air Quality Monitoring Results and Graphical Presentations
<u>Appendix 6.1</u>	Event Action Plans
<u>Appendix 6.2</u>	Notification of Exceedance
<u>Appendix 9.1</u>	Complaint Log
<u>Appendix 10.1</u>	Construction Programme of Individual Contracts

EXECUTIVE SUMMARY

- i. This is the Environmental Monitoring and Audit (EM&A) Monthly Report – **August 2014** specific for Environmental Permit no. EP-122/2002/D. The EM&A report is prepared by the Environmental Team (ET) employed under Contract No. HK/2011/07 – Wan Chai Development Phase II and Central Wanchai Bypass – Sampling, Field Measurement and Testing Works (Stage 2). This report presents the environmental monitoring findings and information recorded during the period of **August 2014**. The cut-off date of reporting is the last day of each reporting month.
- ii. In the reporting month, the principal work activities of the contract are included as follows:
Contract no. HK/2012/08 – Wan Chai Development Phase II – Central- Wan Chai Bypass at Wan Chai West
 - **Diaphragm wall construction works**
 - **Guide wall construction**

Noise Monitoring

- iii. Continuous noise monitoring was conducted at ACL3 – City Hall.
- iv. **Limit level exceedances were recorded at ACL3 – City Hall on 13 August 2014 during daytime in the reporting month. After the investigation, the exceedances were concluded as not project related.**
- v. Due to safety concern, the location of the continuous noise monitoring station at City Hall was finely adjusted to the roof of the City Hall, Low Block on 1 May 2013.

Air Quality Monitoring

- vi. 1-hour and 24-hour Total Suspended Particulates (TSP) monitoring were conducted on every six days basis at ACL1 – City Hall and ACL2a – Contractor HK/2012/08 Site Office.
- vii. **Due to electricity supply, the 24hr TSP monitoring at monitoring station ACL1 was rescheduled from 2 August 2014 to 4 August 2014.**
- viii. **No action or limit level exceedances were recorded in the reporting month.**
- ix. Due to the defective electricity supply found at monitoring station ACL1 and the advice from City Hall Building Management, the air monitoring station ACL1 – City Hall was finely adjusted on 28 Feb 2014 to an alternate electricity supply.
- x. Due to the large scale renovation works at People's Liberation Army Headquarter, a Proposal for Relocation of Air Quality Monitoring Station at People's Liberation Army Headquarter (ACL2) was formally submitted to EPD on 4th November, 2013.
- xi. Air Quality Monitoring at ACL2 was temporarily suspended during the period from 14th November, 2013 to 3rd December, 2013.



- xii. The Proposal for Relocation of Air Quality Monitoring Station at People's Liberation Army Headquarter (ACL2) was approved by EPD on 27 November 2013.
- xiii. According to the approved proposal for relocation of Air Quality Monitoring station, the action and limit levels of ACL2a shall adopt the reference monitoring result from the baseline air monitoring report for EP/364/2009 in 22 April 2010 in which approved by EPD.
- xiv. The air quality monitoring at ACL2a – Contractor HK/2012/08 Site Office was commenced on 7 December 2013.

Complaints, Notifications of Summons and Successful Prosecutions

- xv. There was no environmental complaint received in this reporting month.

Site Inspections and Audit

- xvi. The Environmental Team (ET) conducted weekly site inspection for Contract no. HK/2012/08 in this reporting period. The Contractors rectified major observations and recommendations made during the audit sessions. No non-conformance was identified during the site inspections.

Future Key Issues

- xvii. In the coming reporting month, the principal work activities of the contract is anticipated as follows:

Contract no. HK/2012/08 – Wan Chai Development Phase II – Central- Wan Chai Bypass at Wan Chai West

- Diaphragm wall construction works
- Guide wall construction

1 INTRODUCTION

1.1 Scope of the Report

1.1.1. Lam Geotechnics Limited (LGL) has been appointed take up the role as the Environmental Team (ET) under Environmental Permit no. EP-122/2002/D to implement the Environmental Monitoring and Audit (EM&A) programme as stipulated in the EM&A Manual of the approved Environmental Impact Assessment (EIA) Report for Central Reclamation Phase III - Studies, Site Investigation, Design and Construction (Register No.: AEIAR-040/2001) since 1 May 2013.

1.1.2. This report documents the finding of EM&A works for Environmental Permit (EP) no. EP-122/2002/D, during the period of [August 2014](#). The cut-off date of reporting is the last day of each reporting month.

1.2 Structure of the Report

Section 1 *Introduction* – details the scope and structure of the report.

Section 2 *Project Background* – summarizes background and scope of the project, site description, project organization and contact details of key personnel during the reporting period.

Section 3 *Status of Regulatory Compliance* – summarizes the status of valid Environmental Permits / Licenses during the reporting period.

Section 4 *Monitoring Requirements* – summarizes all monitoring parameters, monitoring methodology and equipment, monitoring locations, monitoring frequency, criteria and respective event and action plan and monitoring programmes.

Section 5 *Monitoring Results* – summarizes the monitoring results obtained in the reporting period.

Section 6 *Compliance Audit* – summarizes the auditing of monitoring results, all exceedances environmental parameters.

Section 7 *Cumulative Construction Impact due to the Concurrent Projects* – summarizes the relevant cumulative construction impact due to the concurrent activities of the concurrent Projects.



- Section 8** ***Site Inspection*** – summarizes the findings of weekly site inspections undertaken within the reporting period, with a review of any relevant follow-up actions within the reporting period.
- Section 9** ***Complaints, Notification of summons and Prosecution*** – summarizes the cumulative statistics on complaints, notification of summons and prosecution
- Section 10** ***Conclusion***

2 PROJECT BACKGROUND

2.1 Background

2.1.1 Central Reclamation Phase III - Studies, Site Investigation, Design and Construction (hereafter called “the Project”) are Designated Project (DP) under the Environmental Impact Assessment Ordinance (Cap. 499) (EIAO). The Environmental Impact Assessment (EIA) Reports for Central Reclamation Phase III - Studies, Site Investigation, Design and Construction (Register No. AEIAR-040/2001) has been approved on 31 August 2001.

2.2 Scope of the Project and Site Description

2.2.1. The design and construction of Central Reclamation Phase III involves the permanent reclamation and construction and operation of a trunk road and its road tunnel that is shown at [Figure 2.1](#).

2.2.2. The key purpose of the study area encompasses the area of Victoria Harbour to the southeast of the new Outlying Islands Ferry Piers and north of Edinburgh Place and Lung Wui Road. The area extends eastward to Fenwick Pier Street and the Fleet Arcade, and includes the existing GPO, Star Ferry Piers, Queens Pier, City Hall, PLA Headquarters, Hong Kong Red Cross Headquarters building and the Tamar Site. The scope of the Central Reclamation, Phase III includes:

- Reclamation and seawalls, roads and associated services, North Island Line Protection Works and Advance Trunk Road Tunnel (ATRT) for the CWB;
- Re provisioning of Star Ferry Pier, public landing steps, wallah wallah moorings, and motor boat/launch operators' kiosks;
- External cooling water systems which consist of the cooling water pumping shells for future developments, and the re provisioning of existing cooling water pumping stations and associated pipework systems and E&M works;
- Re provisioning of existing Leisure and Cultural Services Department (LCSD)'s facilities;
- Provision of a flood relief path, stormwater culvert extensions, upgrading of hinterland stormwater drainage resulting from the reclamation, demolition of the existing waterfront structures and necessary landscaping;
- The Hong Kong Station Extended Overrun Tunnel (EOT) and associated ventilation structures entrusted for construction within the CR III works;
- Re provisioning of the Government Heliport at the Wan Chai PCWA and re provisioning of the Wan Chai PCWA at Chai Wan Basin.

2.2.3. The project also contains various Schedule 2 DPs that, under the EIAO, require Environmental Permits (EPs) to be granted by the DEP before they may be either constructed

or operated. **Table 2.1** summarises the four individual DPs under this Project. **Figure 2.1** shows the locations of these Schedule 2 DPs.

Table 2.1 Schedule 2 Designated Projects under this Project

Item	Designated Project	EIAO Reference
DP1	Central-Wanchai Bypass (CWB)	Schedule 2, Part I, A.7
DP2	Road P2 and other roads which are classified as primary/district distributor roads	Schedule 2, Part I, A.1
DP3	Reclamation works	Schedule 2, Part I, C.1
DP4	The North Island Line (NIL) Protection Works within CRIII	Schedule 2, Part I, A.7

2.2.4. The designated project work I (DP1) was awarded to China State-Leader Joint Venture HK/2012/08 as part of the Project works by the Civil Engineering and Development Department (CEDD). The construction work under Contract no. HK/2012/08 was commenced on 27 May 2013.

2.3 Project Organization and Contact Personnel

2.3.1 Civil Engineering and Development Department is the overall project controllers for the Central Reclamation Phase III Project. For the construction phase of the Project, Project Engineer, Contractor(s), Environmental Team and Independent Environmental Checker are appointed to manage and control environmental issues.

2.3.2 The proposed project organization and lines of communication with respect to environmental protection works are shown in **Figure 2.2**. Key personnel and contact particulars are summarized in **Table 2.2**:

Table 2.2 Contact Details of Key Personnel

Party	Role	Post	Name	Contact No.	Contact Fax
AECOM	Engineer's Representative for WDII	Principal Resident Engineer	Mr. Frankie Fan	2587 1778	2587 1877
	Engineer's Representative for CWB	Principal Resident Engineer	Mr. Peter Poon	3922 3388	3912 3010
China State-Leader JV	Contractor under Contract no. HK/2012/08	Project Director	Mr. Andrew Tse	9137 1811	2877 1522
		Project Manager	Mr. Victor Wu	9193 8871	



Party	Role	Post	Name	Contact No.	Contact Fax
		Deputy Project Manager	Mr. Eddie Chung	9189 8118	
		Site Agent	Mr. Paul Lui	9095 7922	
		Environmental Officer	Mr. James Ma	9130 9549	
		Environmental Supervisor	Mr. Y. L. HO	9856 5669	
ENVIRON Hong Kong Limited	Independent Environmental Checker (IEC)	Independent Environmental Checker (IEC)	Mr. David Yeung	3465 2888	3465 2899
Lam Geotechnics Limited	Environmental Team (ET)	Environmental Team Leader (ETL)	Mr. Raymond Dai	2882 3939	2882 3331

2.3.3 In this reporting month, the principal work activities of the contract is included as follows:

Contract no. HK/2012/08 – Wan Chai Development Phase II – Central- Wan Chai Bypass at Wan Chai West

- Diaphragm wall construction works
- Guide wall construction

2.3.4 In coming reporting month, the principal work activities of the contract is anticipated as follows:

Contract no. HK/2012/08 – Wan Chai Development Phase II – Central- Wan Chai Bypass at Wan Chai West

- Diaphragm wall construction works
- Guide wall construction

3 STATUS OF REGULATORY COMPLIANCE

3.1 Status of Environmental Licensing and Permitting under the Project

3.1.1. A summary of the current status on licences and/or permits on environmental protection pertinent to the Project is shown in **Table 3.1**.

Table 3.1 Summary of the current status on licences and/or permits on environmental protection pertinent to the Project

Permits and/or Licences	Reference No.	Issued Date	Status
Environmental Permit	EP-122/2002/D	1 Sep 2009	Valid

3.1.2. The current status on licences and/or permits on environmental protection pertinent for contract no. HK/2012/08 showed in **Table 3.2**.

Table 3.2 Cumulative Summary of Valid Licences and Permits under Contract no. HK/2012/08

Permits and/or Licences	Reference No.	Issued Date	Valid Period/ Expiry Date	Status
Notification of Works Under APCO	355439	4 Feb 2013	N/A	Valid
Registration as a Chemical Waste Producer	5213-134-C3790-01	8 Mar 2013	N/A	Valid
Billing Account under Waste Disposal Ordinance	7016883	18 Feb 2013	18 Jul 2017	Valid
Billing Account under Waste Disposal Ordinance (Dumping by Vessel)	-	-	-	-
Construction Noise Permit	GW-RS0257-14	26 Mar 2014	28 Mar 2014 to 25 Sep 2014	Valid
Water Discharge Licence	WT00018470-2014	6 Mar 2014	31 Mar 2019	Valid
Dumping Permit (Type 1- Open Sea Disposal)	EP/MD/15-079	5 Aug 2014	10 Feb 2015	Valid



Permits and/or Licences	Reference No.	Issued Date	Valid Period/ Expiry Date	Status
Dumping Permit (Type 2- Open Sea Disposal)	EP/MD/15-080	5 Aug 2014	10 Sep 2014	Valid

3.1.3. Implementation status of the recommended mitigation measures during this reporting month is presented in [Appendix 3.1](#).

4 Monitoring Requirements

4.1 Noise Monitoring

NOISE MONITORING STATIONS

4.1.1. The continuous noise monitoring station for the Project is listed and shown in **Table 4.1** and **Figure 4.1**. **Appendix 4.1** shows the established Action/Limit Levels for the monitoring works.

Table 4.1 Continuous Noise Monitoring Stations

District	Station	Description
Central	ACL3	City Hall

NOISE MONITORING PARAMETERS, FREQUENCY AND DURATION

4.1.2. Continuous 24-hour noise monitoring shall be carried out at the designated monitoring stations. The following is an initial guide on the regular monitoring frequency for each station on a 24 hours daily basis when noise generating activities are underway:

- One set of measurements between 0700 and 1900 hours on normal weekdays.
- One set of measurements between 1900 and 2300 hours on normal weekdays and 0700 and 2300 hours on public holidays.
- One set of measurements between 2300 and 0700 hours on next day on every day.

4.1.3. If construction works are extended to include works during the hours of 1900 – 0700 as well as public holidays and Sundays, additional weekly impact monitoring shall be carried out during respective restricted hours periods. Applicable permits under NCO shall be obtained by the Contractor.

MONITORING EQUIPMENT

4.1.4. As referred to in the Technical Memorandum TM issued under the NCO, sound level meters in compliance with the International Electrotechnical Commission Publications 651: 1979 (Type 1) and 804: 1985 (Type 1) specifications shall be used for carrying out the noise monitoring. Immediately prior to and following each noise measurement the accuracy of the sound level meter shall be checked using an acoustic calibrator generating a known sound pressure level at a known frequency. Measurements may be accepted as valid only if the calibration level from before and after the noise measurement agrees to within 1.0 dB.

4.1.5. Noise measurements shall not be made in fog, rain, wind with a steady speed exceeding 5 m/s or wind with gusts exceeding 10 m/s. The wind speed shall be checked with a portable wind speed meter capable of measuring the wind speed in m/s.

4.1.6. The sound level meter shall be checked using an acoustic calibrator generating a known sound pressure level at a known frequency before deployment to the site and during each site visit. Measurements will be accepted as valid only if the calibration level from before and after the noise measurement agrees to within 1.0 dB.

4.2 Air Quality Monitoring

AIR QUALITY MONITORING STATIONS

4.2.1. The air quality monitoring stations for the Project are listed and shown in **Table 4.2** and **Figure 4.1**. **Appendix 4.1** shows the established Action/Limit Levels for the monitoring works.

Table 4.2 Air Quality Monitoring Stations

Station ID	Description
ACL1	City Hall
ACL2a	Contractor HK/2012/08 Site Office

AIR QUALITY MONITORING PARAMETERS, FREQUENCY AND DURATION

4.2.2. One-hour and 24-hour TSP levels should be measured to indicate the impacts of construction dust on air quality. The 24-hour TSP levels shall be measured by following the standard high volume sampling method as set out in the Title 40 of the Code of Federal Regulations, Chapter 1 (Part 50), Appendix B.

4.2.3. All relevant data including temperature, pressure, weather conditions, elapsed-time meter reading for the start and stop of the sampler, identification and weight of the filter paper, and any other local atmospheric factors affecting or affected by site conditions, etc., shall be recorded down in detail.

4.2.4. For regular impact monitoring, the sampling frequency of at least once in every six-days, shall be strictly observed at all the monitoring stations for 24-hour TSP monitoring. For 1-hour TSP monitoring, the sampling frequency of at least three times in every six-days should be undertaken when the highest dust impact occurs.

SAMPLING PROCEDURE AND MONITORING EQUIPMENT

4.2.5. High volume samplers (HVSs) in compliance with the following specifications shall be used for carrying out the 1-hour and 24-hour TSP monitoring:

- 0.6 – 1.7 m³ per minute adjustable flow range;
- Equipped with a timing / control device with +/- 5 minutes accuracy for 24 hours operation;
- Installed with elapsed-time meter with +/- 2 minutes accuracy for 24 hours operation;
- Capable of providing a minimum exposed area of 406 cm²;

- Flow control accuracy: +/- 2.5% deviation over 24-hour sampling period;
- Equipped with a shelter to protect the filter and sampler;
- Incorporated with an electronic mass flow rate controller or other equivalent devices;
- Equipped with a flow recorder for continuous monitoring;
- Provided with a peaked roof inlet;
- Incorporated with a manometer;
- Able to hold and seal the filter paper to the sampler housing at horizontal position;
- Easily changeable filter; and
- Capable of operating continuously for a 24-hour period.

4.2.6. Initial calibration of dust monitoring equipment shall be conducted upon installation and thereafter at bi-monthly intervals. The transfer standard shall be traceable to the internationally recognized primary standard and be calibrated annually. The concern parties such as IEC shall properly document the calibration data for future reference. All the data should be converted into standard temperature and pressure condition.

LABORATORY MEASUREMENT / ANALYSIS

- 4.2.7. A clean laboratory with constant temperature and humidity control, and equipped with necessary measuring and conditioning instruments to handle the dust samples collected, shall be available for sample analysis, and equipment calibration and maintenance. The laboratory should be HOKLAS accredited.
- 4.2.8. Filter paper of size 8" x 10" shall be labelled before sampling. It shall be a clean filter paper with no pinholes, and shall be conditioned in a humidity-controlled chamber for over 24-hours and be pre-weighed before use for the sampling.
- 4.2.9. After sampling, the filter paper loaded with dust shall be kept in a clean and tightly sealed plastic bag. The filter paper shall then be returned to the laboratory for reconditioning in the humidity controlled chamber followed by accurate weighing by an electronic balance with readout down to 0.1 mg. The balance shall be regularly calibrated against a traceable standard.
- 4.2.10. All the collected samples shall be kept in a good condition for 6 months before disposal.
- 4.2.11. Current calibration certificates of equipment are presented in **Appendix 4.2.**

5 MONITORING RESULTS

5.0.1. The environmental monitoring will be implemented based on the division of works areas of each designated project managed under different contracts with separate FEP applied by individual contractors. Overall layout showing work areas of various contracts, latest status of work commencement and monitoring stations is shown in [Figure 2.1](#) and [Figure 4.1](#). The monitoring results are presented in according to the Individual Contract(s).

5.0.2. In the reporting month, the concurrent contract is:

- Contract no. HK/2012/08 – Wan Chai Development Phase II – Central – Wan Chai Bypass at Wan Chai West.

5.0.3. The environment monitoring schedules for reporting month and coming month are presented in [Appendix 5.1](#).

5.1 Noise Monitoring Results

5.1.1 Due to safety concerned, the location of the continuous noise monitoring station at City Hall was finely adjusted to the roof of the City Hall, Low Block on 1 May 2013.

5.1.2 The proposed division of noise monitoring stations is summarized in Table 5.1 below.

Table 5.1 Continuous Noise Monitoring Stations for Contract no. HK/2012/08

Location ID	District	Description
ACL3	Central	City Hall

Remarks: Continuous noise monitoring results and graphical presentation for ACL3 during restricted hours and night time period are for information only.

5.1.3 Limit level exceedances were recorded on 13 August 2014 during daytime in the reporting month. After checking with Contractor, no construction activity was conducted on 13 August 2014. In addition, thunderstorm warning for the concern location and red rainstorm warning were hoisting during the recorded period. As such, the exceedances were considered to be contributed by the adverse weather condition and not related to Project.

5.1.4 Continuous noise monitoring results measured in this reporting period are reviewed and summarized. Details of continuous noise monitoring results and graphical presentation can be referred to [Appendix 5.2](#).

5.2 Air Quality Monitoring Results

5.2.1 The proposed division of air quality monitoring stations are summarized in **Table 5.2** below.

Table 5.2 Air Quality Monitoring Station for Contract no. HK/2012/08

Station	Description
ACL1	City Hall
ACL2a	Contractor HK/2012/08 Site Office

- 5.2.2 Due to the defective electricity supply found at monitoring station ACL1 and the advice from City Hall Building Management, the air monitoring station ACL1 – City Hall was finely adjusted on 28 Feb 2014 to an alternate electricity supply.
- 5.2.3 Due to the large scale renovation works at People’s Liberation Army Headquarter, a Proposal for Relocation of Air Quality Monitoring Station at People’s Liberation Army Headquarter (ACL2) was formally submitted to EPD on 4th November, 2013.
- 5.2.4 Air Quality Monitoring at ACL2 was temporarily suspended during the period from 14th November, 2013 to 3rd December, 2013.
- 5.2.5 The Proposal for Relocation of Air Quality Monitoring Station at People’s Liberation Army Headquarter (ACL2) was approved by EPD on 27 November 2013.
- 5.2.6 According to the approved proposal for relocation of Air Quality Monitoring station, the action and limit levels of ACL2a shall adopt the reference monitoring result from the baseline air monitoring report for EP/364/2009 in 22 April 2010 in which approved by EPD.
- 5.2.7 The air quality monitoring at ACL2a – Contractor HK/2012/08 Site Office was commenced on 7 December 2013.
- 5.2.8 No action or limit level exceedance was recorded at ACL1 – City Hall and ACL2a – Contractor HK/2012/08 Site Office in the reporting month.
- 5.2.9 The air quality monitoring results measured in this reporting period are reviewed and summarized. Details of air quality monitoring results and graphical presentation can be referred in **Appendix 5.3**.

5.3 Waste Monitoring Results

5.3.1 Inert and non-inert C&D wastes were disposed in this reporting month. Details of the waste flow table are summarized in **Table 5.3**.

Table 5.3 Details of Waste Disposal for Contract no. HK/2012/08

Waste Type	Quantity this month	Cumulative Quantity-to-Date	Disposal / Dumping Grounds
Inert C&D materials disposed, m3	Nil 1869	396 4529	TM38 TKO137
Inert C&D materials recycled, m3	NIL	NIL	NIL
Non-inert C&D materials disposed, m3	45	305	SENT Landfill
Non-inert C&D materials recycled, m3	NIL	NIL	NIL
Chemical waste disposed, kg	NIL	NIL	NIL

6 Compliance Audit

6.0.1. The Event Action Plan for construction noise and air quality are presented in [Appendix 6.1](#).

6.1 Noise Monitoring

6.1.1. Limit level exceedances were recorded at ACL3- City Hall on 13 August 2014 during daytime in this reporting month. After the investigation, the exceedances were concluded as non-project related.

6.2 Air Quality Monitoring

6.1.2. No action or limit level exceedance was recorded at ACL1 – City Hall and ACL2a – Contractor HK/2012/08 Site Office in this reporting month.

6.3 Review of the Reasons for and the Implications of Non-compliance

6.3.1. There was no non-compliance from the site audits in the reporting period. The observations and recommendations made in each individual site audit session were presented in Section 8.

6.4 Summary of action taken in the event of and follow-up on non-compliance

6.4.1. There was no particular action taken since no non-compliance was recorded from the site audits in the reporting period.

7 Cumulative Construction Impact due to the Concurrent Projects

- 7.0.1. This section addresses the relevant cumulative construction impact due to the concurrent activities of the current projects including the Central Reclamation Phase III (CRIII), Wan Chai Development Phase II (WDII), Central-WanChai Bypass (CWB), Island Eastern Corridor Link projects (IECL) and Wan Chai Development Phase II – Central – Wan Chai Bypass at Wan Chai East (CWB Tunnel).
- 7.0.2. According to the Final EM&A report of Central Reclamation Phase III (CRIII) for Contract HK 12/02, the major construction activities were completed by end of January 2014 and no construction activities were undertaken thereafter and the water quality monitoring was completed in October 2011. As such, it is considered that there were no cumulative construction impact due to the concurrent activities of the current projects with the Central Reclamation Phase III (CRIII) undertaken by contractor HK12/02 in the reporting month.
- 7.0.3. According to the construction programme of Wan Chai Development Phase II, Central-Wan Chai Bypass and Island Eastern Corridor Link projects, the major construction activity under Wan Chai Development Phase II were marine works at HKCEC areas, tunnel works at Wan Chai East and filling works at Wan Chai West. The major construction activities under Central-Wan Chai Bypass and Island Eastern Corridor Link Projects were bridge construction and tunnel works at Central Interchange, land base bored pilling works at Victoria Park Road and ELS, segment launching works and tunnel works at North Point area. The major environmental impact was water quality impact at Causeway Bay and Wan Chai. Marine-based construction activities were filling works at WanChai West and removal of temporary reclamation at TS4, TS2 and EX-PCWA at Wan Chai East in the reporting month.
- 7.0.4. No significant air impact from construction activities was anticipated in the reporting month. Besides, no project-related exceedances were recorded during the air and noise environmental monitoring events in the reporting month. Thus, it is evaluated that the cumulative construction impact from the concurrent projects including Central Reclamation Phase III (CRIII), Wan Chai Development Phase II (WDII), Central-WanChai Bypass (CWB), Island Eastern Corridor Link projects (IECL) was insignificant.

8 Environmental Site Audit

8.0.1. Four site inspections for Contract no. HK/2012/08 were carried out on 5, 12, 19 and 26 August 2014 in the reporting month. The results of inspection and outcome are summarized in Table 8.1

Table 8.1 Summary of Environmental Inspections for Contract no. HK/2012/08

Item	Date	Observations	Action taken by Contractor	Outcome
140826_01	26-August-14	Used oil containers should be disposed or stored properly in a designated area.	Used oil containers stored in designated area	Completion as observed on 2 September 2014

9 COMPLAINTS, NOTIFICATION OF SUMMONS AND PROSECUTION

- 9.0.1. No environmental complaint was received in the reporting period.
- 9.0.2. The details of cumulative complaint log and updated summary of complaints are presented in **Appendix 9.1**
- 9.0.3. Cumulative statistic on complaints and successful prosecutions are summarized in **Table 9.1** and **Table 9.2** respectively.

Table 9.1 Cumulative Statistics on Complaints

Reporting Period	No. of Complaints
July 2013 – July 2014	0
August 2014	0
Total	0

Table 9.2 Cumulative Statistics on Successful Prosecutions

Environmental Parameters	Cumulative No. Brought Forward	No. of Successful Prosecutions this month (Offence Date)	Cumulative No. Project-to-Date
Air	0	0	0
Noise	0	0	0
Water	0	0	0
Waste	0	0	0
Total	0	0	0

10 CONCLUSION

- 10.0.1. The EM&A programme was carried out in accordance with the EM&A Manual requirements, minor alterations to the programme proposed were made in response to changing circumstances.
- 10.0.2. The scheduled construction activities and the recommended mitigation measures for the coming month are listed in **Table 10.1**. The construction programmes of individual contracts are provided in [Appendix 10.1](#).

Table 10.1 Summary of Key Construction Activities of Individual Contract(s) to be commenced in Coming Reporting Month

Contract No.	Key Construction Works	Recommended Mitigation Measures
HK/2012/08	<ul style="list-style-type: none"> • Diaphragm wall construction works • Guide wall construction 	<ul style="list-style-type: none"> • Dust control during dust generating works; • Implementation of proper noise pollution control; and • Provision of protection to ensure no runoff out of site area or direct discharge into public drainage system.



Figure 2.1

Project Layout

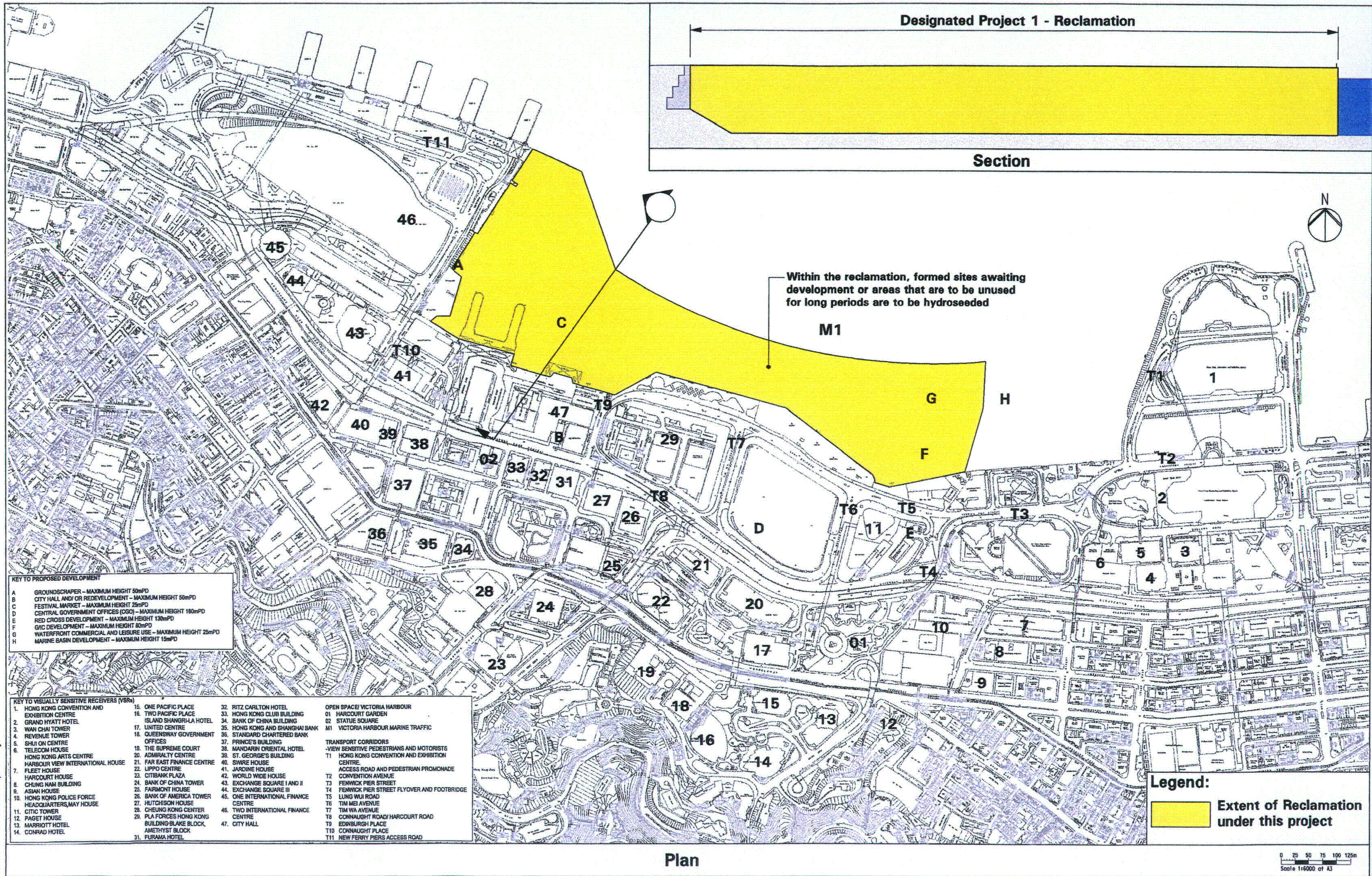

KEY TO PROPOSED DEVELOPMENT

A	GROUNDSCRAPER - MAXIMUM HEIGHT 50mPD
B	CITY HALL AND/OR REDEVELOPMENT - MAXIMUM HEIGHT 50mPD
C	FESTIVAL MARKET - MAXIMUM HEIGHT 25mPD
D	CENTRAL GOVERNMENT OFFICES (CGO) - MAXIMUM HEIGHT 180mPD
E	RED CROSS DEVELOPMENT - MAXIMUM HEIGHT 130mPD
F	G/C DEVELOPMENT - MAXIMUM HEIGHT 80mPD
G	WATERFRONT COMMERCIAL AND LEISURE USE - MAXIMUM HEIGHT 25mPD
H	MARINE BASIN DEVELOPMENT - MAXIMUM HEIGHT 15mPD

KEY TO VISUALLY SENSITIVE RECEIVERS (VSRs)

1. HONG KONG CONVENTION AND EXHIBITION CENTRE	15. ONE PACIFIC PLACE	32. RITZ CARLTON HOTEL	OPEN SPACE/ VICTORIA HARBOUR
2. GRAND HYATT HOTEL	16. TWO PACIFIC PLACE	33. HONG KONG CLUB BUILDING	01. HARCOURT GARDEN
3. WAN CHAI TOWER	17. UNITED CENTRE	34. BANK OF CHINA BUILDING	02. STATUE SQUARE
4. REVENUE TOWER	18. QUEENSWAY GOVERNMENT OFFICES	35. HONG KONG AND SHANGHAI BANK	M1. VICTORIA HARBOUR MARINE TRAFFIC
5. SHUI ON CENTRE	19. THE SUPREME COURT	36. STANDARD CHARTERED BANK	
6. TELECOM HOUSE	20. ADMIRALTY CENTRE	37. PRINCE'S BUILDING	TRANSPORT CORRIDORS
7. HONG KONG ARTS CENTRE	21. FAR EAST FINANCE CENTRE	38. MANDARIN ORIENTAL HOTEL	-VIEW SENSITIVE PEDESTRIANS AND MOTORISTS
8. HARBOUR VIEW INTERNATIONAL HOUSE	22. LIPOO CENTRE	39. ST. GEORGE'S BUILDING	T1. HONG KONG CONVENTION AND EXHIBITION CENTRE
9. FLEET HOUSE	23. CITIBANK PLAZA	40. SWIRE HOUSE	ACCESS ROAD AND PEDESTRIAN PROMONADE
10. HARCOURT HOUSE	24. BANK OF CHINA TOWER	41. JARDINE HOUSE	T2. CONVENTION AVENUE
11. CHUNG NAM BUILDING	25. FAIRMONT HOUSE	42. WORLD WIDE HOUSE	T3. FENWICK PIER STREET
12. ASIAN HOUSE	26. BANK OF AMERICA TOWER	43. EXCHANGE SQUARE I AND II	T4. FENWICK PIER STREET FLYOVER AND FOOTBRIDGE
13. HONG KONG POLICE FORCE HEADQUARTERS, MAY HOUSE	27. HUTCHISON HOUSE	44. EXCHANGE SQUARE III	T5. LUNG WUI ROAD
14. CITIC TOWER	28. CHEUNG KONG CENTER	45. ONE INTERNATIONAL FINANCE CENTRE	T6. TIM MEI AVENUE
15. PAGET HOUSE	29. PLA FORCES HONG KONG BUILDING-BLAKE BLOCK, AMETHYST BLOCK	46. TWO INTERNATIONAL FINANCE CENTRE	T7. TIM WA AVENUE
16. MARRIOTT HOTEL	30. FURAMA HOTEL	47. CITY HALL	T8. CONNAUGHT ROAD/ HARCOURT ROAD
17. CONRAD HOTEL			T9. EDINBURGH PLACE
			T10. CONNAUGHT PLACE
			T11. NEW FERRY PIERS ACCESS ROAD

Designated Project 1 - Reclamation
Layout Plan and Section

Figure 14.9

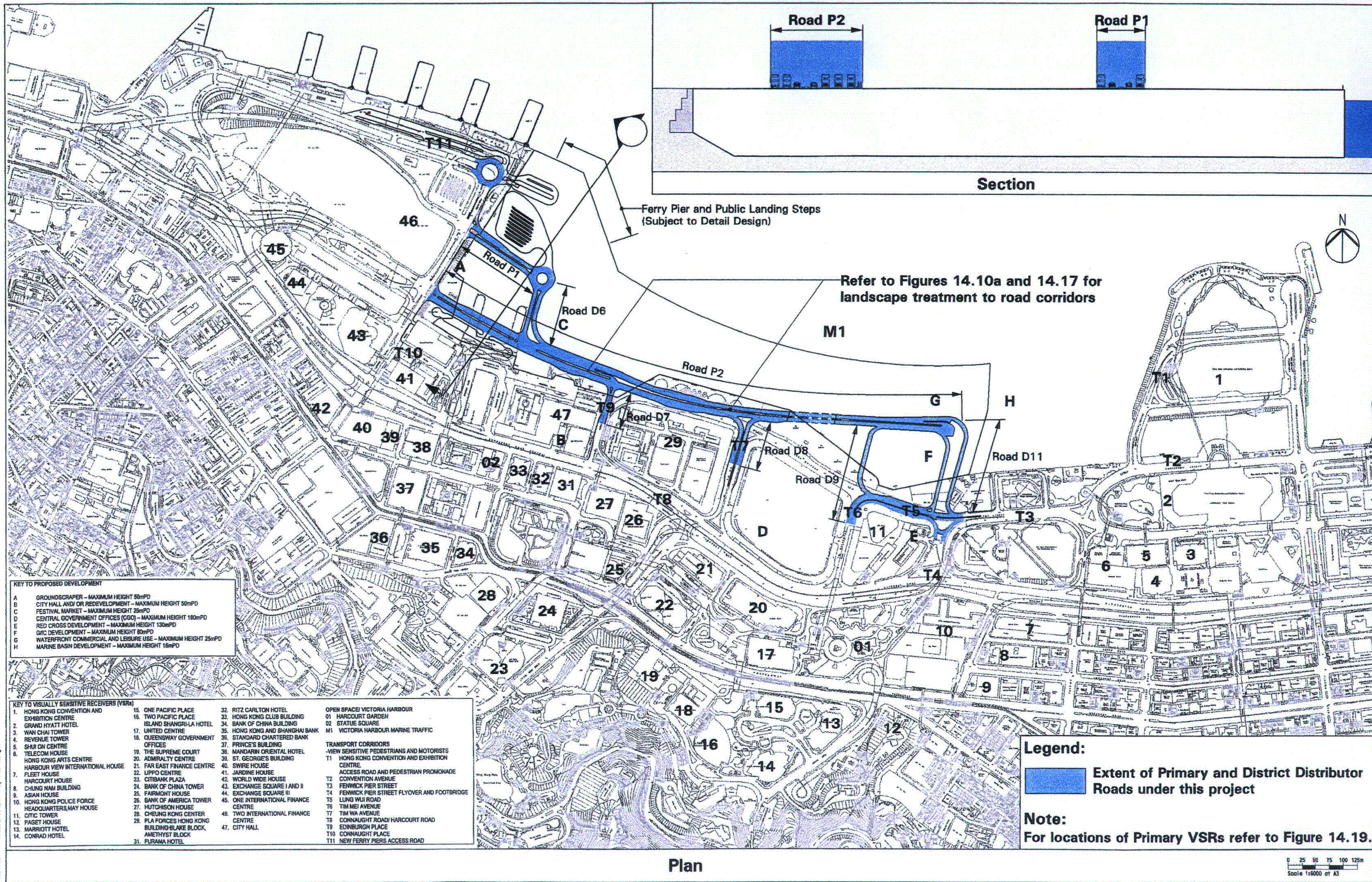

Designated Project 2 - Primary and District Distributor Roads Layout Plan and Section

Figure 14.10

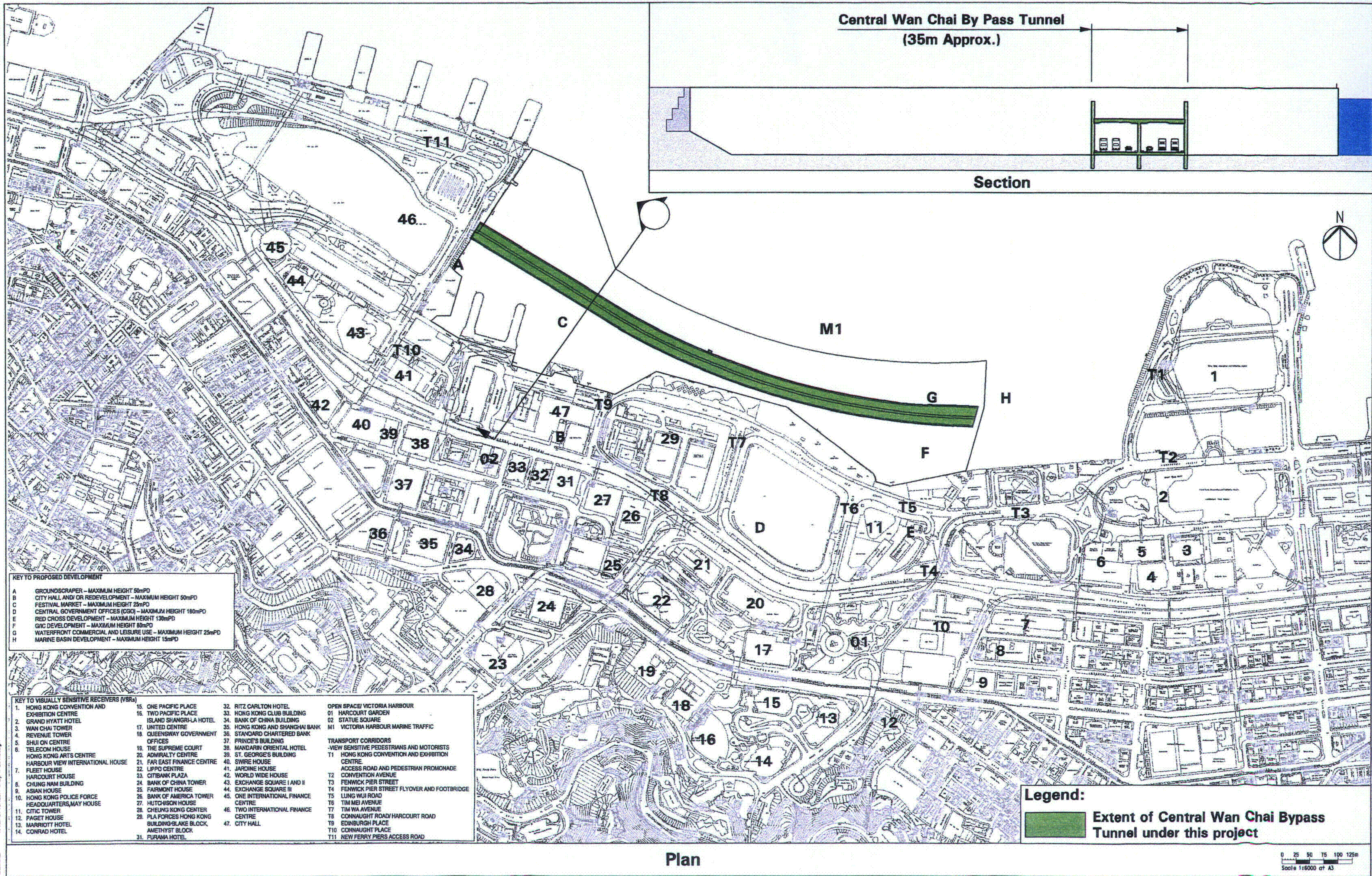

KEY TO PROPOSED DEVELOPMENT

A	GROUNDSCRAPER - MAXIMUM HEIGHT 50mPD
B	CITY HALL AND/OR REDEVELOPMENT - MAXIMUM HEIGHT 50mPD
C	FESTIVAL MARKET - MAXIMUM HEIGHT 25mPD
D	CENTRAL GOVERNMENT OFFICES (CGO) - MAXIMUM HEIGHT 180mPD
E	RED CROSS DEVELOPMENT - MAXIMUM HEIGHT 130mPD
F	GVC DEVELOPMENT - MAXIMUM HEIGHT 80mPD
G	WATERFRONT COMMERCIAL AND LEISURE USE - MAXIMUM HEIGHT 25mPD
H	MARINE BASIN DEVELOPMENT - MAXIMUM HEIGHT 15mPD

KEY TO VISUALLY SENSITIVE RECEIVERS (VSRs)

1. HONG KONG CONVENTION AND EXHIBITION CENTRE	15. ONE PACIFIC PLACE	32. RITZ CARLTON HOTEL	OPEN SPACE/ VICTORIA HARBOUR
2. GRAND HYATT HOTEL	16. TWO PACIFIC PLACE	33. HONG KONG CLUB BUILDING	01 HARCOURT GARDEN
3. WAN CHAI TOWER	17. UNITED CENTRE	34. BANK OF CHINA BUILDING	02 STATUE SQUARE
4. REVENUE TOWER	18. QUEENSWAY GOVERNMENT OFFICES	35. HONG KONG AND SHANGHAI BANK	M1 VICTORIA HARBOUR MARINE TRAFFIC
5. SHUI ON CENTRE	19. THE SUPREME COURT	36. STANDARD CHARTERED BANK	TRANSPORT CORRIDORS
6. TELECOM HOUSE	20. ADMIRALTY CENTRE	37. PRINCE'S BUILDING	-VIEW SENSITIVE PEDESTRIANS AND MOTORISTS
7. FLEET HOUSE	21. FAR EAST FINANCE CENTRE	38. MANDARIN ORIENTAL HOTEL	T1 HONG KONG CONVENTION AND EXHIBITION CENTRE
8. HARCOURT HOUSE	22. LIPPO CENTRE	39. ST. GEORGE'S BUILDING	ACCESS ROAD AND PEDESTRIAN PROMENADE CONVENTION AVENUE
9. ASIAN HOUSE	23. CITIBANK PLAZA	40. SWIRE HOUSE	T2
10. HONG KONG POLICE FORCE HEADQUARTERS, MAY HOUSE	24. BANK OF CHINA TOWER	41. JAPANESE HOUSE	T3
11. CITIC TOWER	25. FAIRMONT HOUSE	42. WORLD WIDE HOUSE	T4 FENWICK PIER STREET FLYOVER AND FOOTBRIDGE
12. PAGET HOUSE	26. BANK OF AMERICA TOWER	43. EXCHANGE SQUARE I AND II	T5 LUNG WUI ROAD
13. MARRIOTT HOTEL	27. HUTCHISON HOUSE	44. EXCHANGE SQUARE III	T6 TIM MEI AVENUE
14. CONRAD HOTEL	28. CHEUNG KONG CENTER	45. ONE INTERNATIONAL FINANCE CENTRE	T7 TIM WA AVENUE
	29. PLA FORCES HONG KONG BUILDING-SLAKE BLOCK, AMETHYST BLOCK	46. TWO INTERNATIONAL FINANCE CENTRE	T8 CONNAUGHT ROAD/ HARCOURT ROAD
	31. PURANA HOTEL	47. CITY HALL	T9 EDINBURGH PLACE
			T10 CONNAUGHT PLACE
			T11 NEW FERRY PIERS ACCESS ROAD

Legend:

Extent of Central Wan Chai Bypass Tunnel under this project

Designated Project 3 - Central Wan Chai Bypass Tunnel
Layout Plan and Section

Figure 14.11

PRINTED BY: CND
 FILENAME: H:\d\off\3\21\94\T-0716.dgn
 10/01/94 10:11:11

© 2001 ACL

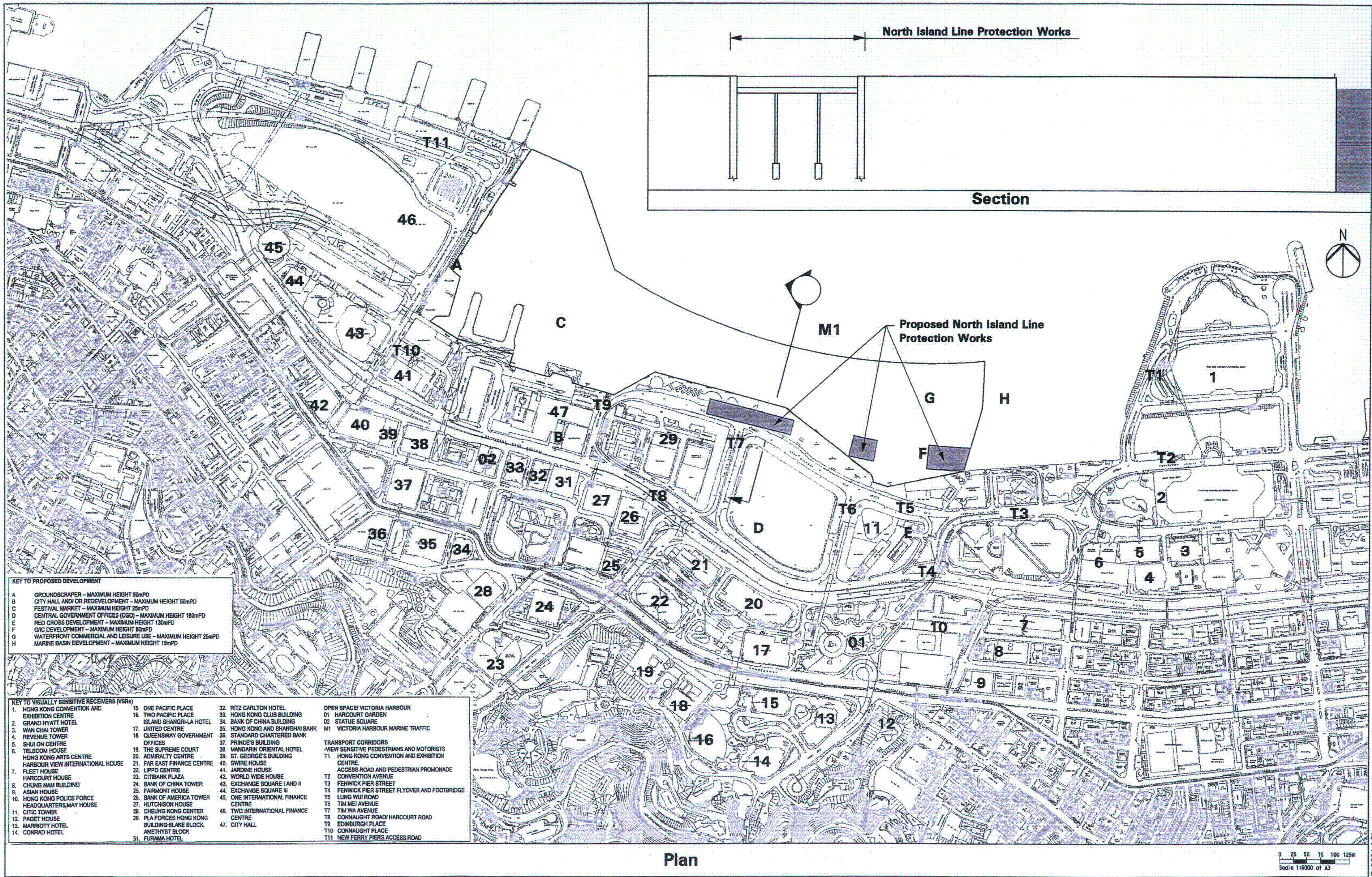

KEY TO PROPOSED DEVELOPMENT

A	GROUNDSCRAPER - MAXIMUM HEIGHT 50mPD
B	CITY HALL AND/OR REDEVELOPMENT - MAXIMUM HEIGHT 50mPD
C	FESTIVAL MARKET - MAXIMUM HEIGHT 25mPD
D	CENTRAL GOVERNMENT OFFICES (CGO) - MAXIMUM HEIGHT 180mPD
E	RED CROSS DEVELOPMENT - MAXIMUM HEIGHT 130mPD
F	GIC DEVELOPMENT - MAXIMUM HEIGHT 80mPD
G	WATERFRONT COMMERCIAL AND LEISURE USE - MAXIMUM HEIGHT 25mPD
H	MARINE BASIN DEVELOPMENT - MAXIMUM HEIGHT 15mPD

KEY TO VISUALLY SENSITIVE RECEIVERS (VSRs)

1.	HONG KONG CONVENTION AND EXHIBITION CENTRE	15.	ONE PACIFIC PLACE	32.	RITZ CARLTON HOTEL	41.	JARDINE HOUSE
2.	GRAND HYATT HOTEL	16.	TWO PACIFIC PLACE	33.	HONG KONG CLUB BUILDING	42.	WORLD WIDE HOUSE
3.	WAN CHAI TOWER	17.	ISLAND SHANGRI-LA HOTEL	34.	BANK OF CHINA BUILDING	43.	EXCHANGE SQUARE I AND II
4.	REVENUE TOWER	18.	UNITED CENTRE	35.	HONG KONG AND SHANGHAI BANK	44.	EXCHANGE SQUARE III
5.	SHUI ON CENTRE	19.	QUEENSWAY GOVERNMENT OFFICES	36.	STANDARD CHARTERED BANK	45.	ONE INTERNATIONAL FINANCE CENTRE
6.	TELECOM HOUSE	20.	ADMIRALTY CENTRE	37.	PRINCE'S BUILDING	46.	TWO INTERNATIONAL FINANCE CENTRE
7.	HONG KONG ARTS CENTRE	21.	FAR EAST FINANCE CENTRE	38.	MANDARIN ORIENTAL HOTEL	47.	CITY HALL
8.	HARBOUR VIEW INTERNATIONAL HOUSE	22.	LIPPO CENTRE	39.	ST. GEORGE'S BUILDING		
9.	FLEET HOUSE	23.	CITIBANK PLAZA	40.	SWIRE HOUSE		
10.	HARBOUR COURT HOUSE	24.	BANK OF CHINA TOWER	41.	JARDINE HOUSE		
11.	CHUNG NAM BUILDING	25.	FARMONT HOUSE	42.	WORLD WIDE HOUSE		
12.	ASIAN HOUSE	26.	BANK OF AMERICA TOWER	43.	EXCHANGE SQUARE I AND II		
13.	HONG KONG POLICE FORCE HEADQUARTERS, MAY HOUSE	27.	HUTCHISON HOUSE	44.	EXCHANGE SQUARE III		
14.	CITIC TOWER	28.	CHEUNG KONG CENTER	45.	ONE INTERNATIONAL FINANCE CENTRE		
		29.	PLA FORCES HONG KONG BUILDING-BLAKE BLOCK	46.	TWO INTERNATIONAL FINANCE CENTRE		
		30.	AMETHYST BLOCK	47.	CITY HALL		
		31.	FURAMA HOTEL				

TRANSPORT CORRIDORS

01.	HARCOURT GARDEN
02.	STATUE SQUARE
03.	VICTORIA HARBOUR MARINE TRAFFIC
04.	ACCESS ROAD AND PEDESTRIAN PROMENADE
05.	FENWICK PIER STREET
06.	FENWICK PIER STREET FLYOVER AND FOOTBRIDGE
07.	LUNG WUI ROAD
08.	TIM MEI AVENUE
09.	TIM WA AVENUE
10.	CONNAUGHT ROAD/HARCOURT ROAD
11.	EDINBURGH PLACE
12.	CONNAUGHT PLACE
13.	NEW FERRY PIERS ACCESS ROAD

Designated Project 4 - North Island Line Protection Works
Layout Plan and Section

Figure 14.12

FILENAME: T:\d\off\13\2817\ep\1_0111.dgn

© 2001 ACL



Figure 2.2

Project Organization Chart



Project Organization Chart

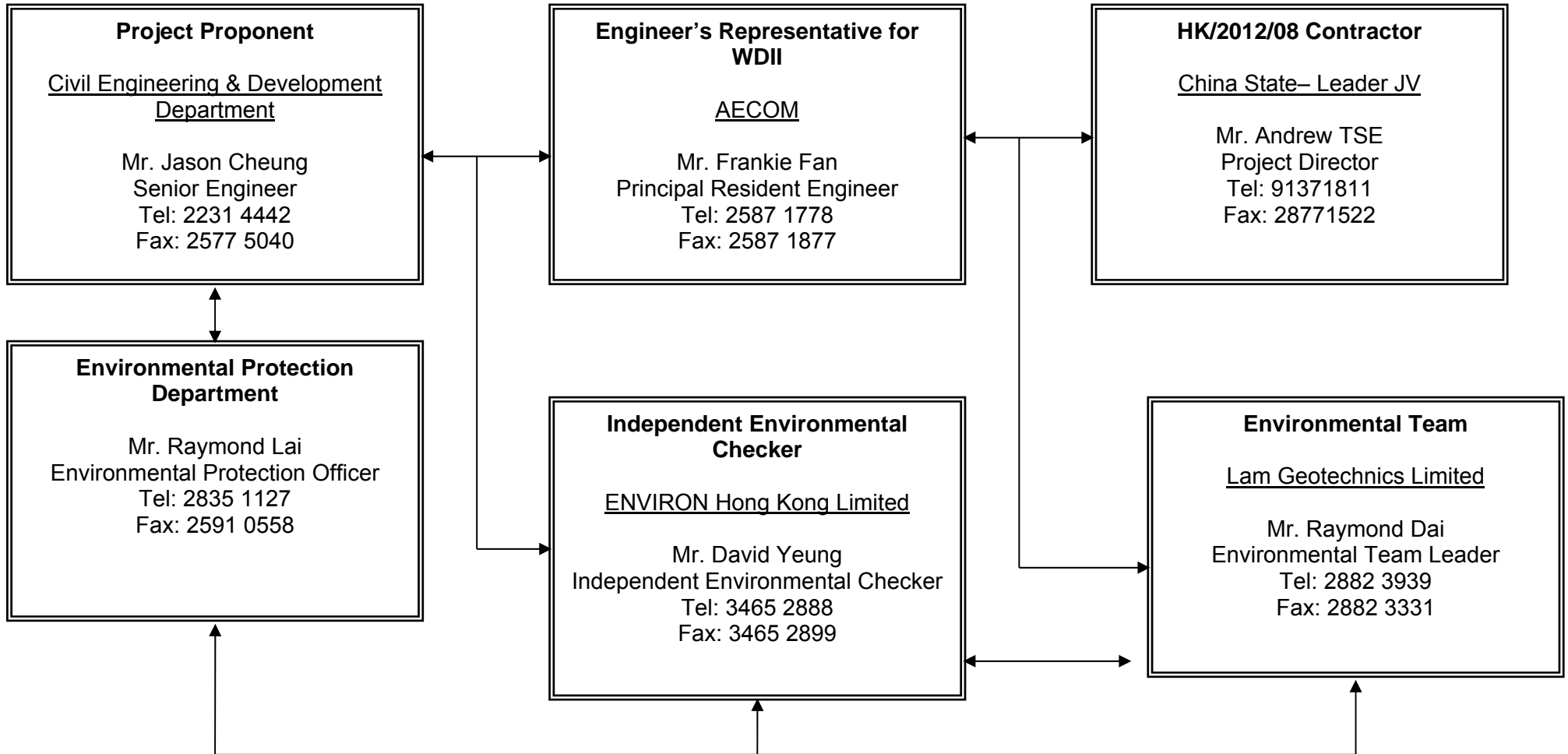

Figure 2.2



Figure 4.1

Locations of Monitoring Stations



DO NOT SCALE DRAWINGS. VERIFY ALL DIMENSIONS ON SITE

LEGEND:

- DUST MONITORING STATIONS
- ▲ NOISE MONITORING STATION

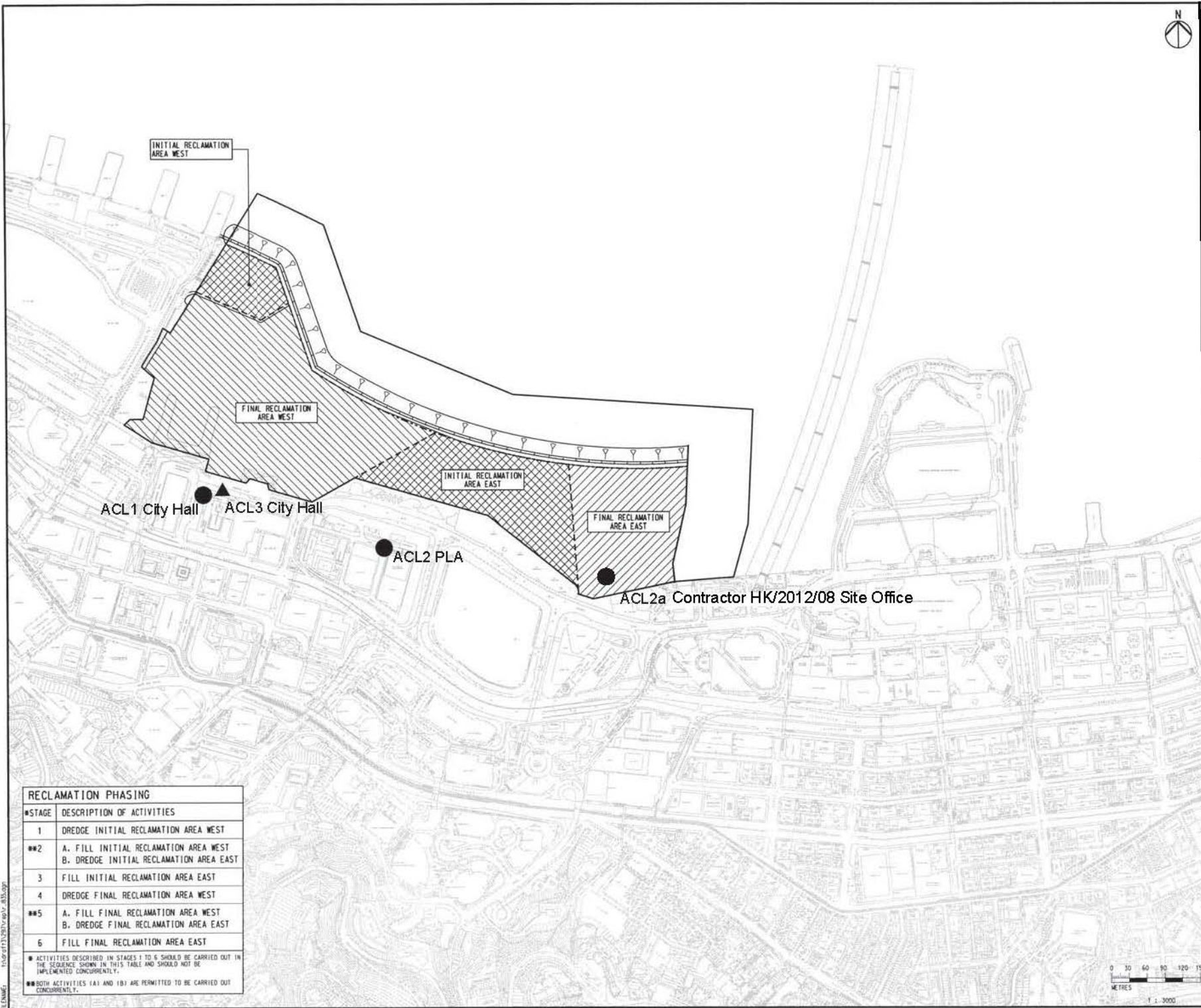

RECLAMATION PHASING	
#STAGE	DESCRIPTION OF ACTIVITIES
1	DREDGE INITIAL RECLAMATION AREA WEST
**2	A. FILL INITIAL RECLAMATION AREA WEST B. DREDGE INITIAL RECLAMATION AREA EAST
3	FILL INITIAL RECLAMATION AREA EAST
4	DREDGE FINAL RECLAMATION AREA WEST
**5	A. FILL FINAL RECLAMATION AREA WEST B. DREDGE FINAL RECLAMATION AREA EAST
6	FILL FINAL RECLAMATION AREA EAST

● ACTIVITIES DESCRIBED IN STAGES 1 TO 6 SHOULD BE CARRIED OUT IN THE SEQUENCE SHOWN IN THIS TABLE AND SHOULD NOT BE IMPLEMENTED CONCURRENTLY.
 ● BOTH ACTIVITIES (A) AND (B) ARE PERMITTED TO BE CARRIED OUT CONCURRENTLY.



Fig 4.1 Location of monitoring stations

PRINTED BY: [illegible] # APR 03 14:22:27 11/04/07 11:29:10 vsp/.../833097



Appendix 3.1

Environmental Mitigation Implementation Schedule

IMPLEMENTATION SCHEDULE OF THE PROPOSED MITIGATION MEASURES

No.	Activity	Mitigation/EIA Recommendations	Responsibility for Implementation	Location Duration completion of measures	Implementation Stage C : Construction D : Design	Permit Conditions apply to	Relevant Guidelines Legislation
1	Operational Traffic Noise*	The openings of ventilation buildings or ventilation shafts should be placed carefully and ideally should be such that they are not facing directly onto any NSR.	Various	Area Wide, Proposals at design stage for Implementation during construction	D/C	N/A	--
2	Operational Air Quality	Air intakes for commercial/G/IC buildings should be placed such that they are at locations where contours indicate AQOs are met.	ArchSD/Private sector +	CRIII During development of sites Completion of CRIII	Development of CRIII	Carry forward to design stage	6
3	Operational Water Quality	Provision of grit traps for surface drainage	TDD's Contractor	New roads and paved areas During construction End of construction	C	P, R, A, C	7
4	Operational Landscape and Visual	Operational stage landscape and visual mitigation measures should include + <ul style="list-style-type: none"> · Implementation of the Waterfront Promenade, Statue Square Corridor, Historic Corridor, Civic Corridor, Arts and Entertainment Corridor, Streetscape Network, Landscape Decks, and Supplementary Landscape Spaces; · provision of a legible, integrated pedestrian circulation system linking major activity nodes, reinforcing links with adjoining areas, and providing an international quality hard and soft landscape treatment; · provision of a grade separated pedestrian system to minimise vehicular/ pedestrian conflict; · provision of an integrated network of local and regional open spaces for passive and active recreation; · preservation of selected architectural features; · preservation insitu of existing significant vegetation, principally the two Banyan Trees flanking the Tamar Site; · new roads to incorporate suitable streetscape amenity and landscape planting to minimise visual and environmental impacts; 	Various	Area wide, proposals at design stage for implementation during construction	D/C	P	--



No.	Activity	Mitigation/EIA Recommendations	Responsibility for Implementation	Location Duration completion of measures	Implementation Stage C : Construction D : Design	Permit Conditions apply to	Relevant Guidelines Legislation
		<ul style="list-style-type: none"> · existing roads upgraded to 'marry' with the proposed landscape framework; · Hydroseeding of reclamation if there is no immediate use of the site, periphery of the reclamation; · Designated service corridors beneath footpaths to prevent potential impacts upon vegetation during services maintenance; · Sensitively designed colour themes to footpath paving areas; and · Sensitively designed seawall to enhance the recreational value of the future promenade can be included. 	Various	Area wide, proposals at design stage for implementation during construction	D/C	P	--
5	Construction Noise Control Requirements	Use of the following quiet mechanical equipment for construction works : · air compressor; paver; hand held breaker; breaker, excavator mounted; bulldozer; concrete lorry mixer; concrete pump; crane; dump truck; excavator/ loader; grader; lorry ; poker; road roller; vibratory roller;	TDD's Contractor	Works Area During construction End of construction	C	P, R, A, C	-
		Use of noise barriers (in the form of purpose built site hoarding of 3 - 5 m height and surface density of at least 7 kgm ² with cranked top) for the following works: · Hong Kong Station Extended Overrun Tunnels to north of Central Barracks. · North Island Line Protection Works to north of Central Barracks; · Road/Drainage Works to north of Central Barracks; · Culvert F Piling Works to north of City Hall.	TDD's Contractor	Work Sites as stated Start of activity stated End of activity stated	C	P, A	
		· Only well-maintained plant should be operated on-site and plant should be serviced regularly during the construction programme.	TDD's Contractor	Works Area During construction End of construction	C	P,R,A,C	4
		· Silencers or mufflers on construction equipment should be utilised and should be properly maintained during the construction programme.	TDD's Contractor	Works Area During construction End of construction	C	P,R,A,C	4
		· Mobile plant, if any, should be sited as far away from noise sensitive facilities as possible.	TDD's Contractor	Works Area During construction End of construction	C	P,R,A,C	4



No.	Activity	Mitigation/EIA Recommendations	Responsibility for Implementation	Location Duration completion of measures	Implementation Stage C : Construction D : Design	Permit Conditions apply to	Relevant Guidelines Legislation
		· Machines and plant (such as trucks) that may be in intermittent use should be shut down between works periods or should be throttled down to a minimum.	TDD's Contractor	Works Area During construction End of construction	C	P,R,A,C	4
		· Plant known to emit noise strongly in one direction should, wherever possible, be orientated so that the noise is directed away from nearby noise sensitive facilities.	TDD's Contractor	Works Area During construction End of construction	C	P,R,A,C	4
6	Construction Air Quality Control Requirements	· Material stockpiles and other structures should be effectively utilised, wherever practicable, in screening noise from on-site construction activities.	TDD's Contractor	Works Area During construction End of construction	C	P,R,A,C	4
		· Strictly limit truck speed on site to below 10 km per hour and water spraying to keep the haul roads in wet condition.	TDD's Contractor	Works Area During construction End of construction	C	P,R,A,C	6,7
		· Twice daily watering of the site with active operations when the weather and the work site are dry.	TDD's Contractor	Works Area During construction End of construction	C	P,R,A,C	6,7
		· Watering during excavation and material handling.	TDD's Contractor	Works Area During construction End of construction	C	P,R,A,C	6,7
		· Provision of vehicle wheel and body washing facilities at the exit points of the site, combined with cleaning of public roads where necessary.	TDD's Contractor	Works Area During construction End of construction	C	P,R,A,C	6,7
		· Tarpaulin covering of all dusty vehicle loads transported to, from and between site locations.	TDD's Contractor	Works Area During construction End of construction	C	P,R,A,C	6,7
		· Covers for dusty stockpiles	TDD's Contractor	Works Area During construction End of construction	C	P,R,A,C	6
		· All plant shall be maintained ot prevent any undue air emmissions	TDD's Contractor	Works Area	C	P,R,A,C	6



No.	Activity	Mitigation/EIA Recommendations	Responsibility for Implementation	Location Duration completion of measures	Implementation Stage C : Construction D : Design	Permit Conditions apply to	Relevant Guidelines Legislation
				During construction End of construction			
7	Construction Water Quality Control Requirements	<p>Specific Measures Associated with Dredging Works</p> <ul style="list-style-type: none"> · the use of closed clamshell (water-tight) grab dredgers to remove seriously contaminated material such that the amount of SS and other pollutants released from the marine mud and pore water can be minimised; · the prohibition of stockpiling of any moderately or seriously contaminated marine sediment, and careful control of stockpiling of any uncontaminated sediment to prevent runoff, resuspension and odour nuisances; and · the control of dredging and bulk reclamation filling rates within acceptable limits. Based upon the construction sequence developed for this study the maximum dredging and filling rates adopted for Final Reclamation Area East were : Maximum Dredging Rate : 184 m²/hour Maximum Daily Filling Rate : 17,727 m³/day (for bulk reclamation filling) <p>Maximum dredging and filling rates for other reclamation sites should take account of information contained in Table 10.14 of the EIA Report and envisaged construction sequence.</p> <ul style="list-style-type: none"> · no dredging should take place under very bad weather conditions. 	TDD's Contractor	Whole reclamation area During reclamation works End of reclamation works	C	R	7
		<ul style="list-style-type: none"> · silt curtain around dredging sites to be provided as necessary. <p>Specific Measure for Marine Disposal of Dredged Materials and Marine Sand Filling Works</p> <ul style="list-style-type: none"> · all vessels should be sized such that adequate clearance is maintained between vessels and the sea bed at all states of the tide to ensure that undue turbidity is not generated by turbulence from vessel movement or propeller wash; · all hopper barges and dredgers should be fitted with tight fitting seals to their bottom openings to prevent leakage of material; · loading of hopper barges should be controlled to prevent splashing of dredged or filling material to the surrounding water, and barges or hoppers should not be filled to a level which will cause the overflow of materials or polluted water during loading or 	TDD's Contractor	Whole reclamation area During reclamation works End of reclamation works	C	R	7

No.	Activity	Mitigation/EIA Recommendations	Responsibility for Implementation	Location Duration completion of measures	Implementation Stage C : Construction D : Design	Permit Conditions apply to	Relevant Guidelines Legislation
		transportation;					
		<ul style="list-style-type: none"> · the works should cause no visible foam, oil, grease, scum, litter or other objectionable matter to be present on the water within the site or dumping grounds; · bulk filling should be carried out, where feasible, behind completed seawall to above high water mark. In general and where physically practical, filling should not be carried out without the seawall having been substantially completed for a distance of 100m – 200m ahead of filling; and · fill materials should comply with technical specification requirements and be taken from approved sources only. The maximum fines content of marine sand should be limited to 5% as assumed in the water quality assessments. · transport of contaminated mud (or filling material) to the marine disposal site (or works site) should, wherever possible, be by split barge of not less than 750 m³ capacity, well maintained and capable of rapid opening and discharge at the disposal site; · the dredged material should be disposed in the pit by bottom dumping, at a location within the pit specified by the MFC; · discharge should be undertaken rapidly and the hoppers should then immediately be closed. Material adhering to the sides of the hopper should not be washed out of the hopper and the hopper should remain closed until the barge next return to the disposal site; · the dumping vessel is not required to station but will be guided by the site staff managing the disposal facility. The vessel crew should be familiar with such operational procedures; · monitoring of the barge loading to ensure that loss of material does not take place during transportation; and · Transport barges or vessels shall be equipped with automatic self-monitoring devices. 	TDD's Contractor	<p>Whole reclamation area</p> <p>During reclamation works</p> <p>End of reclamation works</p>	C	R	7



No.	Activity	Mitigation/EIA Recommendations	Responsibility for Implementation	Location Duration completion of measures	Implementation Stage C : Construction D : Design	Permit Conditions apply to	Relevant Guidelines Legislation
		<p>Specific Measures Associated with Dredging and Filling Works when CRIII Dredging and Filling Works are being constructed concurrently with WDII Dredging and Filling Works</p> <ul style="list-style-type: none"> · deployment of silt curtains around the dredging and fill release points to contain SS within the construction site during dredging and filling; · deployment of silt screens at the cooling water intakes and WSD salt water intakes to further minimise the intake of SS within the sea water. 	TDD's Contractor	<p>Reclamation Areas as appropriate</p> <p>When CRIII and WDII - Dredging and Filling Works occur concurrently</p> <p>End of Concurrent Works</p>	C	R	-
		<p>Specific Measures Associated with Floating Debris</p> <p>The result of the floating debris simulation has shown that the intermediate layout of the proposed reclamation has potential to trap floating rubbish. Monitoring and control of the construction activities should be taken to prevent the release of construction waste and rubbish from the construction site. Collection of floating debris should be carried out at least once every day by the CRIII Contractor, and more frequently (two or three times per day) at the water body south of the Initial Reclamation Area West and near the cooling water intakes where large substances could block the screens and filter pipes of the intakes and reduce their efficiency. Debris should be collected and taken to landfill sites for disposal.</p>	TDD's Contractor	<p>Whole reclamation area</p> <p>During construction</p> <p>At end of construction</p>	C	R	-
		<p>Specific Measures for Dealing with Culvert L Outfall at Completion of CRIII Eastern Seawall</p> <p>As a mitigation measure, to avoid the accumulation of water borne pollutants within a temporary embayment to the east of CRIII, an impermeable barrier, suspended from a floating boom on the water surface and extending down to the seabed, will be erected by the CRIII Contractor on completion of the CRIII eastern seawall. The barrier will channel the stormwater discharge flows from Culvert L to the outside of the embayment. The CRIII Contractor will maintain this barrier until the WDII Contractor takes possession of this site, whereupon the WDII Contractor will takeover the maintenance of this barrier until the reclamation works in this area are carried out and the new Culvert L extension is constructed.</p>	TDD's Consultant	<p>Culvert L Outfall</p> <p>During Construction</p> <p>To handover to WDII Contractor</p>	C	R	--



No.	Activity	Mitigation/EIA Recommendations	Responsibility for Implementation	Location Duration completion of measures	Implementation Stage C : Construction D : Design	Permit Conditions apply to	Relevant Guidelines Legislation
		<p>Construction Run-off and Drainage</p> <ul style="list-style-type: none"> · Control of Site Surface Runoff: <ul style="list-style-type: none"> - Surface run-off from construction sites should be discharged into storm drains via adequately designed sand/silt removal facilities such as sand traps, silt traps and sediment basins. Channels or earth bunds or sand bag barriers should be provided on site to properly direct stormwater to such silt removal facilities. Perimeter channels at site boundaries should be provided where necessary. Catchpits and perimeter channels should be constructed in advance of site formation works and earthworks. - Silt removal facilities, channels and manholes should be maintained. - Construction works should be programmed to minimise soil excavation works in rainy seasons (April to September). If excavation in soil cannot be avoided, temporarily exposed slope surfaces should be covered and temporary access roads should be protected by crushed stone or gravel, as excavation proceeds. Intercepting channels should be provided. - Earthworks final surfaces should be well compacted and the subsequent permanent work or surface protection should be carried out immediately after the final surfaces are formed to prevent erosion caused by rainstorms. Appropriate drainage such as intercepting channels should be provided where necessary. - Measures should be taken to minimise the ingress of rainwater into trenches. If excavation of trenches in wet seasons is necessary, they should be dug and backfilled in short sections. Rainwater pumped out from trenches or foundation excavations should be discharged into storm drains via silt removal facilities. - Open stockpiles of construction materials should be covered. - Manholes should be adequately covered and temporarily sealed. 	TDD's Contractor	<p>Works Area</p> <p>During construction</p> <p>End of construction</p>	C	P,R,A,C	7
		<ul style="list-style-type: none"> · Groundwater <ul style="list-style-type: none"> - Groundwater pumped out of tunnels or caverns should be discharged into storm drains after the removal of silt. 					



No.	Activity	Mitigation/EIA Recommendations	Responsibility for Implementation	Location Duration completion of measures	Implementation Stage C : Construction D : Design	Permit Conditions apply to	Relevant Guidelines Legislation
		<ul style="list-style-type: none"> · Boring and Drilling Water - Water used in ground boring and drilling for site investigation or rock/soil anchoring should as far as practicable be recirculated after sedimentation. Wastewater should be discharged into storm drains via silt removal facilities. · Wastewater from Concrete Batching and Precast Concrete Casting - Wastewater generated from the washing down of mixer trucks and drum mixers and similar equipment should wherever practicable be recycled. The discharge of wastewater should be kept to a minimum. - To prevent pollution from wastewater overflow, the pump sump of any water recycling system should be provided with an on-line standby pump of adequate capacity and with automatic alternating devices. - Under normal circumstances, surplus wastewater may be discharged into foul sewers after treatment in silt removal and pH adjustment facilities (to within the pH range of 6 to 10). Disposal of wastewater into storm drains will require more elaborate treatment. <p>Surface run-off should be segregated from the concrete mixing and casting yard area as much as possible, and diverted to the stormwater drainage system. Surface run-off contaminated by materials in a concrete mixing area or casting yard should be adequately treated before disposal into stormwater drains.</p>	TDD's Contractor	<p>Work Area</p> <p>During construction</p> <p>End of construction</p>	C	P,R,A,C	7
		<ul style="list-style-type: none"> · Wheel Washing Water - All vehicles and plant should be cleaned before they leave the construction site. A wheel washing bay should be provided at every site exit if practicable and wash-water should have sand and silt settled out or removed before discharging into storm drains. The section of construction road between the wheel washing bay and the public road should be paved with backfall to reduce vehicle tracking of soil and to prevent site run-off from entering public road drains. · Bentonite Slurries - Bentonite slurries should be reconditioned and reused wherever practicable. If the disposal of a certain residual quantity cannot be avoided, the used slurry may be disposed of at the marine spoil site subject to obtaining a marine dumping licence from EPD (on a case-by-case basis). 	TDD's Contractor	<p>Work Area</p> <p>During construction</p> <p>End of construction</p>	C	P,R,A,C	7



No.	Activity	Mitigation/EIA Recommendations	Responsibility for Implementation	Location Duration completion of measures	Implementation Stage C : Construction D : Design	Permit Conditions apply to	Relevant Guidelines Legislation
		<ul style="list-style-type: none"> - If the used bentonite slurry is intended to be disposed of through the public drainage system, it should be treated to the respective effluent standards applicable to foul sewers, storm drains or the receiving waters as set out in the WPCO Technical Memorandum on Effluent Standards. 					
		<ul style="list-style-type: none"> · Wastewater from Building Construction - Before commencing any demolition works, all sewer and drainage connections should be sealed to prevent building debris, soil, sand etc. from entering public sewers/drains. - Wastewater generated from building construction activities including concreting, plastering, internal decoration, cleaning of works and similar activities should not be discharged into the stormwater drainage system. If the wastewater is to be discharged into foul sewers, it should undergo the removal of settleable solids in a silt removal facility, and pH adjustment as necessary. 					
		<ul style="list-style-type: none"> ·Licensing of Construction Site Discharges within Water Control Zones -All discharges into any drainage or sewerage systems, or inland or coastal waters, or into the ground (e.g. from septic tanks) within a Water Control Zone are controlled under the Water Pollution control Ordinance (WPCO), except the discharge of domestic sewage into foul sewers or the discharge of unpolluted water into storm drains or into the waters of Hong Kong. Construction site discharges are controlled under the WPCO. -Discharges controlled under the WPCO must comply with the terms and conditions of a valid WPCO licence. 					



No.	Activity	Mitigation/EIA Recommendations	Responsibility for Implementation	Location Duration completion of measures	Implementation Stage C : Construction D : Design	Permit Conditions apply to	Relevant Guidelines Legislation
8.	Construction Waste Control Requirements	<p>Specific Measures Associated with Marine sediments</p> <p>In accordance with the WBTC No. 3/2000, the seriously contaminated material must be dredged and transported with great care. Mitigation measures, including the use of close-grab dredgers, shall be incorporated.</p> <p>The dredged contaminated sediment must be effectively isolated from the environment upon final disposal and shall be disposed of at the East Sha Chau Contaminated Mud Pits.</p>	TDD's Contractor	Whole Reclamation Area During Reclamation Works End of Reclamation Work	C	R	7
		<p>Segregation and Disposal of Wastes</p> <ul style="list-style-type: none"> · inert demolition/construction waste material when deemed suitable for reclamation or land formation should be re-used on-site; · non-inert demolition / construction waste material should be disposed of at landfills; · chemical waste as defined by Schedule 1 of the Waste Disposal (Chemical Waste) (General) Regulation, should be stored in accordance with approved methods defined in the Regulation and Code of Practice and the chemical waste disposed of at the Chemical Waste Treatment Facility located at Tsing Yi or an approved recycler; · general refuse should be recycled where possible or disposed of at public landfill. 	TDD's Contractor	Works Areas During Construction End of Construction	C	P, R, A, C	1,8, 9
		<p>Storage, Collection and Transport of Waste</p> <ul style="list-style-type: none"> · wastes should be handled and stored in a manner which ensures that they are held securely without loss or leakage thereby minimising the potential for pollution. Release of these potential pollutants into marine waters during storage, handling or barge transportation should not be permitted as introduction of polluted waters is likely to have detrimental effects on water quality and water sensitive receivers; · only reputable waste hauliers authorised to collect the specific category of waste concerned should be employed; · appropriate measures should be employed to minimise windblown litter and dust during transportation by using enclosed bins, covering trucks or transporting wastes in enclosed containers; · the necessary waste disposal permits and registrations should be obtained from the appropriate authorities, if they are required, in accordance with the Waste Disposal 	TDD's Contractor	Works Areas During Construction End of Construction	C	P, R, A, C	1, 8, 9



No.	Activity	Mitigation/EIA Recommendations	Responsibility for Implementation	Location Duration completion of measures	Implementation Stage C : Construction D : Design	Permit Conditions apply to	Relevant Guidelines Legislation
		Ordinance (Cap 354), Waste Disposal (Chemical Waste) (General) Regulation (Cap 354) and the Crown Land Ordinance; <ul style="list-style-type: none"> · collection of general refuse should be carried out frequently, preferably daily; · waste should only be disposed of at licensed sites and the civil engineering contractor should develop procedures to ensure that illegal disposal of wastes does not occur; · waste storage areas should be well maintained and cleaned regularly; · records should be maintained of the quantities of wastes generated, recycled and disposed, determined by weighing each load or other method; and · A "trip ticket" system should be implemented, if required by Government. 					
9	Construction Landscape and Visual Control Requirements	Construction stage landscape and visual mitigation measures should include : <ul style="list-style-type: none"> · Minimising contractors accesses and working areas as far as possible; · Protection and retention of existing vegetation where possible in accordance with the Hong Kong Government "A Guide to Tree Planting and Maintenance in Urban Hong Kong, Section 5" Care of Trees on Development Sites' and the Country Parks Ordinance · Transplanting of trees where appropriate; · Advance planting and visual screening; · Conservation of top soil; · Design of the temporary works areas so as to optimise eventual use as promenade and public open space; and · Sensitively designed site hoarding. 	TDD's design consultant	Area wide during design and contract preparation	D	P, R, A, C	11, 12, 13,14
10	Monitoring and Audit	To be carried out in accordance with the Schedule in the EM and A Manual	TDD*/Contractor/ RSS TDD's design consultant	Works areas During construction End of construction and within one year of operational phase Area wide during design and contract preparation	C/O D	P, R, A, C P, R, A, C	1 11,12,13,14



Relevant Guidelines Legislation

1. Environmental Impact Assessment Ordinance Technical Memorandum (EIAO)
2. HKPSG
3. ExCo Criteria for ITR
4. Noise Control Ordinance
5. The ProPECC Note PN2/93 (Construction Noise daytime limits)
6. Air Pollution Control Ordinance (APCO)
7. Water Pollution Control Ordinance (WPCO)(Cap. 358)
8. Waste Disposal Ordinance (Cap 354)
9. Waste Disposal (Chemical Waste)(General) Regulation (Cap 354)
10. Land Ordinance (Cap 28)
11. WBTC 25/92 Allocation of Space for Urban Trees
12. WBTC 25/93 Control of Visual Impact of Slopes
13. WBTC 18/94 Management and Maintenance of both Natural Vegetation and Landscape Works
14. WBTC 24/94 and PELBTC 3/94 "Tree Preservation"
15. Antiquities and Monuments Ordinance (Cap 53)

Permit Conditions apply to

- P Primary and District Distributor Roads
- R Reclamation
- A North Island Line Protection Works
- C Central and Wanchai Bypass
- + These items should be excluded from any Environmental Permit conditions as these refer to future development of the area (which is not designated under the EIAO), and are not related to reclamation and dredging activities which are designated, and can hence be controlled through EP conditions.
- * Normally undertaken by a specialist monitoring team employed directly by the proponent and audited by the Environmental Works Checker.



Appendix 4.1

Action and Limit Level



Action and Limit Level

Action and Limit Level for Noise Monitoring

Time Period	Action Level	Limit Level
07:00 - 19:00 hours on normal weekdays	When one documented complaint is received.	70 dB(A)

Action and Limit Level for Air Monitoring

Monitoring Locations	1-hour TSP Level in $\mu\text{g}/\text{m}^3$		24-hour TSP Level in $\mu\text{g}/\text{m}^3$	
	Action Level	Limit Level	Action Level	Limit Level
ACL1 - City Hall	460	500	163	260
ACL2a - Contractor HK/2012/08 Site Office	300.1	500	187.3	260



Appendix 4.2

Copies of Calibration Certificates



TISCH ENVIRONMENTAL, INC.
 145 SOUTH MIAMI AVE
 VILLAGE OF CLEVELAND, OH
 45002
 513.467.9000
 877.263.7610 TOLL FREE
 513.467.9009 FAX

ORIFICE TRANSFER STANDARD CERTIFICATION WORKSHEET TE-5025A

Date - Jul 14, 2014 Rootsmeter S/N 0438320 Ta (K) - 298
 Operator Tisch Orifice I.D. - 0005 Pa (mm) - 749.3

PLATE OR Run #	VOLUME START (m3)	VOLUME STOP (m3)	DIFF VOLUME (m3)	DIFF TIME (min)	METER DIFF Hg (mm)	ORFICE DIFF H2O (in.)
1	NA	NA	1.00	1.3870	3.2	2.00
2	NA	NA	1.00	0.9830	6.4	4.00
3	NA	NA	1.00	0.8760	7.9	5.00
4	NA	NA	1.00	0.8340	8.8	5.50
5	NA	NA	1.00	0.6860	12.7	8.00

DATA TABULATION

Vstd	(x axis) Qstd	(y axis)	Va	(x axis) Qa	(y axis)
0.9817	0.7078	1.4042	0.9957	0.7179	0.8919
0.9775	0.9944	1.9859	0.9915	1.0086	1.2613
0.9754	1.1135	2.2203	0.9894	1.1294	1.4101
0.9743	1.1683	2.3286	0.9882	1.1849	1.4790
0.9692	1.4128	2.8084	0.9830	1.4330	1.7837
Qstd slope (m) = 1.99175			Qa slope (m) = 1.24720		
intercept (b) = -0.00041			intercept (b) = -0.00026		
coefficient (r) = 0.99991			coefficient (r) = 0.99991		
y axis = SQRT[H2O(Pa/760) (298/Ta)]			y axis = SQRT[H2O(Ta/Pa)]		

CALCULATIONS

Vstd = Diff. Vol [(Pa-Diff. Hg)/760] (298/Ta)
 Qstd = Vstd/Time

Va = Diff Vol [(Pa-Diff Hg)/Pa]
 Qa = Va/Time

For subsequent flow rate calculations:

Qstd = 1/m{ [SQRT(H2O(Pa/760) (298/Ta))] - b}
 Qa = 1/m{ [SQRT H2O(Ta/Pa)] - b}



Lam Geotechnics Limited

Calibration Data for High Volume Sampler (TSP Sampler)

Location : ACL1 Calibration Date : 21-Jun-14
 Equipment no. : EL222 Calibration Due Dat : 21-Aug-14

CALIBRATION OF CONTINUOUS FLOW RECORDER

Ambient Condition			
Temperature, T _a	301	Kelvin	Pressure, P _a
			1003 mmHg

Orifice Transfer Standard Information					
Equipment No.	EL086	Slope, m _c	2.01968	Intercept, b _c	-0.02746
Last Calibration Date	15-Jul-13	$(H \times P_a / 1013.3 \times 298 / T_a)^{1/2}$ $= m_c \times Q_{std} + b_c$			
Next Calibration Date	15-Jul-14				

Calibration of TSP						
Calibration Point	Manometer Reading			Q _{std} (m ³ / min.) X-axis	Continuous Flow Recorder, W (CFM)	IC (W(P _a /1013.3x298/T _a) ^{1/2} /35.31) Y-axis
	(up)	(down)	(difference)			
1	5.8	5.8	11.6	1.6830	56	55.4363
2	4.4	4.4	8.8	1.4676	48	47.5168
3	3.7	3.7	7.4	1.3469	43	42.5672
4	2.2	2.2	4.4	1.0417	34	33.6578
5	1.5	1.5	3.0	0.8626	26	25.7383

By Linear Regression of Y on X						
Slope, m	=	<u>35.2472</u>	Intercept, b	=	<u>-4.1457</u>	
Correlation Coefficient*	=	<u>0.9981</u>				
Calibration Accepted	=	<u>Yes/No**</u>				

* if Correlation Coefficient < 0.990, check and recalibration again.

** Delete as appropriate.

Remarks : _____

Calibrated by : Felix Li Checked by : Pauline Wong
 Date : 21-Jun-14 Date : 21-Jun-14



Lam Geotechnics Limited

Calibration Data for High Volume Sampler (TSP Sampler)

Location : ACL1 Calibration Date : 22-Aug-14
 Equipment no. : EL222 Calibration Due Date : 22-Oct-14

CALIBRATION OF CONTINUOUS FLOW RECORDER

Ambient Condition			
Temperature, T _a	303	Kelvin	Pressure, P _a
			1009 mmHg

Orifice Transfer Standard Information					
Equipment No.	EL086	Slope, m _c	1.99175	Intercept, b _c	-0.00041
Last Calibration Date	14-Jul-14	$(H \times P_a / 1013.3 \times 298 / T_a)^{1/2}$ $= m_c \times Q_{std} + b_c$			
Next Calibration Date	14-Jul-15				

Calibration of TSP						
Calibration Point	Manometer Reading			Q _{std} (m ³ / min.) X-axis	Continuous Flow Recorder, W (CFM)	IC (W(P _a /1013.3x298/T _a) ^{1/2} /35.31) Y-axis
	(up)	(down)	(difference)			
1	5.7	5.7	11.4	1.6778	55	54.4285
2	4.3	4.3	8.6	1.4573	47	46.5116
3	3.7	3.7	7.4	1.3518	43	42.5532
4	2.5	2.5	5.0	1.1112	33	32.6571
5	1.8	1.8	3.6	0.9429	27	26.7194

By Linear Regression of Y on X						
Slope, m	=	<u>38.1806</u>	Intercept, b	=	<u>-9.3737</u>	
Correlation Coefficient*	=	<u>0.9996</u>				
Calibration Accepted	=	<u>Yes/No**</u>				

* if Correlation Coefficient < 0.990, check and recalibration again.

** Delete as appropriate.

Remarks : _____

Calibrated by : Felix Li Checked by : Pauline Wong
 Date : 22-Aug-14 Date : 22-Aug-14



Lam Geotechnics Limited

Calibration Data for High Volume Sampler (TSP Sampler)

Location : ACL2a Calibration Date : 21-Jun-14
 Equipment no. : EL111 Calibration Due Date : 21-Aug-14

CALIBRATION OF CONTINUOUS FLOW RECORDER

Ambient Condition			
Temperature, T _a	301	Kelvin	Pressure, P _a
			1003 mmHg

Orifice Transfer Standard Information					
Equipment No.	EL086	Slope, m _c	2.01968	Intercept, b _c	-0.02746
Last Calibration Date	15-Jul-13	$(H \times P_a / 1013.3 \times 298 / T_a)^{1/2}$ $= m_c \times Q_{std} + b_c$			
Next Calibration Date	15-Jul-14				

Calibration of TSP						
Calibration Point	Manometer Reading			Q _{std} (m ³ / min.) X-axis	Continuous Flow Recorder, W (CFM)	IC (W(P _a /1013.3x298/T _a) ^{1/2} /35.31) Y-axis
	(up)	(down)	(difference)			
1	4.9	4.9	9.8	1.5480	58	57.4162
2	3.7	3.7	7.4	1.3469	52	51.4766
3	3.1	3.1	6.2	1.2340	46	45.5370
4	2.0	2.0	4.0	0.9939	38	37.6175
5	1.3	1.3	2.6	0.8039	26	25.7383

By Linear Regression of Y on X

Slope, m = 41.9012 Intercept, b = -6.1108

Correlation Coefficient* = 0.9911

Calibration Accepted = Yes/No**

* if Correlation Coefficient < 0.990, check and recalibration again.

** Delete as appropriate.

Remarks : _____

Calibrated by : Felix Li Checked by : Pauline Wong
 Date : 21-Jun-14 Date : 21-Jun-14



Lam Geotechnics Limited

Calibration Data for High Volume Sampler (TSP Sampler)

Location : ACL2a Calibration Date : 22-Aug-14
 Equipment no. : EL111 Calibration Due Dat : 22-Oct-14

CALIBRATION OF CONTINUOUS FLOW RECORDER

Ambient Condition			
Temperature, T _a	303	Kelvin	Pressure, P _a
			1009 mmHg

Orifice Transfer Standard Information					
Equipment No.	EL086	Slope, m _c	1.99175	Intercept, b _c	-0.00041
Last Calibration Date	14-Jul-14	$(H \times P_a / 1013.3 \times 298 / T_a)^{1/2}$ $= m_c \times Q_{std} + b_c$			
Next Calibration Date	14-Jul-15				

Calibration of TSP						
Calibration Point	Manometer Reading			Q _{std} (m ³ / min.) X-axis	Continuous Flow Recorder, W (CFM)	IC (W(P _a /1013.3x298/T _a) ^{1/2} /35.31) Y-axis
	(up)	(down)	(difference)			
1	5.0	5.0	10.0	1.5714	59	58.3869
2	3.9	3.9	7.8	1.3878	53	52.4492
3	3.6	3.6	7.2	1.3334	48	47.5012
4	2.5	2.5	5.0	1.1112	39	38.5947
5	1.2	1.2	2.4	0.7699	24	23.7506

By Linear Regression of Y on X

Slope, m = 43.8363 Intercept, b = -9.9906

Correlation Coefficient* = 0.9974

Calibration Accepted = Yes/No**

* if Correlation Coefficient < 0.990, check and recalibration again.

** Delete as appropriate.

Remarks : _____

Calibrated by : Felix Li Checked by : Pauline Wong
 Date : 22-Aug-14 Date : 22-Aug-14



CERTIFICATE OF CALIBRATION

Certificate No.: 14CA0303 02 Page 1 of 2

Item tested

Description:	Sound Level Meter (Type 1)	Microphone
Manufacturer:	Larson Davis	-
Type/Model No.:	831	377B02
Serial/Equipment No.:	0003227	SNLW135892
Adaptors used:	-	-

Item submitted by

Customer Name:	Lam Geotechnics Ltd.
Address of Customer:	-
Request No.:	-
Date of receipt:	03-Mar-2014

Date of test: 04-Mar-2014

Reference equipment used in the calibration

Description:	Model:	Serial No.	Expiry Date:	Traceable to:
Multi function sound calibrator	B&K 4226	2288444	22-Jun-2014	CIGISMEC
Signal generator	DS 360	33873	15-Apr-2014	CEPREI
Signal generator	DS 360	61227	15-Apr-2014	CEPREI

Ambient conditions

Temperature:	22 ± 1 °C
Relative humidity:	60 ± 10 %
Air pressure:	1000 ± 10 hPa

Test specifications

- 1, The Sound Level Meter has been calibrated in accordance with the requirements as specified in BS 7580: Part 1: 1997 and the lab calibration procedure SMTP004-CA-152.
- 2, The electrical tests were performed using an electrical signal substituted for the microphone which was removed and replaced by an equivalent capacitance within a tolerance of ±20%.
- 3, The acoustic calibration was performed using an B&K 4226 sound calibrator and corrections was applied for the difference between the free-field and pressure responses of the Sound Level Meter.

Test results

This is to certify that the Sound Level Meter conforms to BS 7580: Part 1: 1997 for the conditions under which the test was performed.

Details of the performed measurements are presented on page 2 of this certificate.

Actual Measurement data are documented on worksheets.

Approved Signatory:

Huang Jian Yin/Feng Jun Qi

Date: 04-Mar-2014

Company Chop:

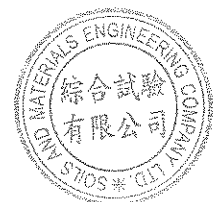

Comments: The results reported in this certificate refer to the condition of the instrument on the date of calibration and carry no implication regarding the long-term stability of the instrument.



CERTIFICATE OF CALIBRATION

(Continuation Page)

Certificate No.: 14CA0303 02

Page 2 of 2

1, Electrical Tests

The electrical tests were performed using an equivalent capacitance substituted for the microphone. The results are given in below with test status and the estimated uncertainties. The "Pass" means the result of the test is inside the tolerances stated in the test specifications. The "-" means the result of test is outside these tolerances.

Test:	Subtest:	Status:	Expanded Uncertainty (dB)	Coverage Factor
Self-generated noise	A	Pass	0.3	
	C	Pass	0.8	2.1
	Lin	Pass	1.6	2.2
Linearity range for Leq	At reference range, Step 5 dB at 4 kHz	Pass	0.3	
	Reference SPL on all other ranges	Pass	0.3	
	2 dB below upper limit of each range	Pass	0.3	
	2 dB above lower limit of each range	Pass	0.3	
		Pass	0.3	
Linearity range for SPL	At reference range, Step 5 dB at 4 kHz	Pass	0.3	
	A	Pass	0.3	
	C	Pass	0.3	
Frequency weightings	Lin	Pass	0.3	
	Time weightings	Single Burst Fast	Pass	0.3
	Single Burst Slow	Pass	0.3	
Peak response	Single 100µs rectangular pulse	N/A	N/A	
R.M.S. accuracy	Crest factor of 3	Pass	0.3	
Time weighting I	Single burst 5 ms at 2000 Hz	Pass	0.3	
	Repeated at frequency of 100 Hz	Pass	0.3	
Time averaging	1 ms burst duty factor 1/10 ³ at 4kHz	Pass	0.3	
	1 ms burst duty factor 1/10 ⁴ at 4kHz	Pass	0.3	
Pulse range	Single burst 10 ms at 4 kHz	Pass	0.4	
Sound exposure level	Single burst 10 ms at 4 kHz	Pass	0.4	
Overload indication	SPL	Pass	0.3	
	Leq	Pass	0.4	

2, Acoustic tests

The complete sound level meter was calibrated on the reference range using a B&K 4226 acoustic calibrator with 1000Hz and SPL 94 dB. The sensitivity of the sound level meter was adjusted. The test result at 125 Hz and 8000 Hz are given in below with test status and the estimated uncertainties.

Test:	Subtest	Status	Expanded Uncertainty (dB)	Coverage Factor
Acoustic response	Weighting A at 125 Hz	Pass	0.3	
	Weighting A at 8000 Hz	Pass	0.5	

3, Response to associated sound calibrator

N/A

The expanded uncertainties have been calculated in accordance with the ISO Publication "Guide to the expression of uncertainty in measurement", and gives an interval estimated to have a level of confidence of 95%. A coverage factor of 2 is assumed unless explicitly stated.

Calibrated by:

Date:

Fung Chi Yip
04-Mar-2014

- End -

Checked by:

Date:

Lam Tze Wai
04-Mar-2014

The standard(s) and equipment used in the calibration are traceable to national or international recognised standards and are calibrated on a schedule to maintain the required accuracy level.



CERTIFICATE OF CALIBRATION

Certificate No.: 14CA0529 01-02

Page: 1 of 2

Item tested

Description: Acoustical Calibrator (Class 1)
Manufacturer: Rion Co., Ltd.
Type/Model No.: NC-73
Serial/Equipment No.: 10465798
Adaptors used: -

Item submitted by

Customer: Lam Geotechnics Limited
Address of Customer: -
Request No.: -
Date of receipt: 29-May-2014

Date of test: 30-May-2014

Reference equipment used in the calibration

Description:	Model:	Serial No.	Expiry Date:	Traceable to:
Lab standard microphone	B&K 4180	2412857	13-May-2015	SCL
Preamplifier	B&K 2673	2239857	10-Apr-2015	CEPREI
Measuring amplifier	B&K 2610	2346941	08-Apr-2015	CEPREI
Signal generator	DS 360	61227	09-Apr-2015	CEPREI
Digital multi-meter	34401A	US36087050	17-Dec-2014	CEPREI
Audio analyzer	8903B	GB41300350	07-Apr-2015	CEPREI
Universal counter	53132A	MY40003662	11-Apr-2015	CEPREI

Ambient conditions

Temperature: 22 ± 1 °C
Relative humidity: 60 ± 10 %
Air pressure: 1000 ± 10 hPa

Test specifications

- The Sound Calibrator has been calibrated in accordance with the requirements as specified in IEC 60942 1997 Annex B and the lab calibration procedure SMTP004-CA-156.
- The calibrator was tested with its axis vertical facing downwards at the specific frequency using insert voltage technique.
- The results are rounded to the nearest 0.01 dB and 0.1 Hz and have not been corrected for variations from a reference pressure of 1013.25 hectoPascals as the maker's information indicates that the instrument is insensitive to pressure changes.

Test results

Details of the performed measurements are presented on **page 2** of this certificate.

Approved Signatory:

Huang Jian Min/Feng Jun Qi

Date: 30-May-2014

Company Chop:



Comments: The results reported in this certificate refer to the condition of the instrument on the date of calibration and carry no implication regarding the long-term stability of the instrument.



CERTIFICATE OF CALIBRATION

(Continuation Page)

Certificate No.: 14CA0529 01-02

Page: 2 of 2

1, Measured Sound Pressure Level

The output Sound Pressure Level in the calibrator head was measured at the setting and frequency shown using a calibrated laboratory standard microphone and insert voltage technique. The results are given in below with the estimated uncertainties.

Frequency Shown Hz	Output Sound Pressure Level Setting dB	Measured Output Sound Pressure Level dB	(Output level in dB re 20 μ Pa)
			Estimated Expanded Uncertainty dB
1000	94.00	94.57	0.10

2, Sound Pressure Level Stability - Short Term Fluctuations

The Short Term Fluctuations was determined by measuring the maximum and minimum of the fast weighted DC output of the B&K 2610 measuring amplifier over a 20 second time interval as required in the standard. The Short Term Fluctuation was found to be:

At 1000 Hz **STF = 0.001 dB**
Estimated expanded uncertainty 0.005 dB

3, Actual Output Frequency

The determination of actual output frequency was made using a B&K 4180 microphone together with a B&K 2673 preamplifier connected to a B&K 2610 measuring amplifier. The AC output of the B&K 2610 was taken to an universal counter which was used to determine the frequency averaged over 20 second of operation as required by the standard. The actual output frequency at 1 KHz was:

At 1000 Hz **Actual Frequency = 965.6 Hz**
Estimated expanded uncertainty 0.1 Hz Coverage factor k = 2.2

4, Total Noise and Distortion

For the Total Noise and Distortion measurement, the unfiltered AC output of the B&K 2610 measuring amplifier was connected to an Agilent Type 8903 B distortion analyser. The TND result at 1 KHz was:

At 1000 Hz **TND = 0.9 %**
Estimated expanded uncertainty 0.7 %

The expanded uncertainties have been calculated in accordance with the ISO Publication "Guide to the expression of uncertainty in measurement", and gives an interval estimated to have a level of confidence of 95%. A coverage factor of 2 is assumed unless explicitly stated.

- End -

Calibrated by:

Date: 30-May-2014

Fung Chi Yip

Checked by:

Date: 30-May-2014

Lam Tze Wai

The standard(s) and equipment used in the calibration are traceable to national or international recognised standards and are calibrated on a schedule to maintain the required accuracy level.



Appendix 5.1

Monitoring Schedules for Reporting Month and Coming Reporting Month

Contract No. HK/2011/07
 Wan Chai Development Phase II and Central-Wan Chai Bypass
 Sampling, Field Measurement and Testing Works (Stage 2)

**Environmental Monitoring Schedule
 August 2014**

						1-Aug	2-Aug
						24hr TSP	
3-Aug	4-Aug	5-Aug	6-Aug	7-Aug	8-Aug	9-Aug	
24hr TSP (ACL1) 1hr TSP					24hr TSP	1hr TSP	
10-Aug	11-Aug	12-Aug	13-Aug	14-Aug	15-Aug	16-Aug	
			24hr TSP	1hr TSP			
17-Aug	18-Aug	19-Aug	20-Aug	21-Aug	22-Aug	23-Aug	
		24hr TSP	1hr TSP				
24-Aug	25-Aug	26-Aug	27-Aug	28-Aug	29-Aug	30-Aug	
	24hr TSP	1hr TSP					
31-Aug							

**Wan Chai Development Phase II and Central-Wan Chai Bypass
Sampling, Field Measurement and Testing Works (Stage 2)**

**Tentative Environmental Monitoring Schedule
September 2014**

	1-Sep	2-Sep	3-Sep	4-Sep	5-Sep	6-Sep
	24hr TSP	1hr TSP				24hr TSP
7-Sep	1hr TSP				24hr TSP	1hr TSP
14-Sep				24hr TSP	1hr TSP	
21-Sep			24hr TSP	1hr TSP		
28-Sep	24hr TSP	1hr TSP				



Appendix 5.2

Continuous Noise Monitoring Results and Graphical Presentations

Graphic Presentation of Continuous Noise Monitoring Result (ACL3-City Hall)

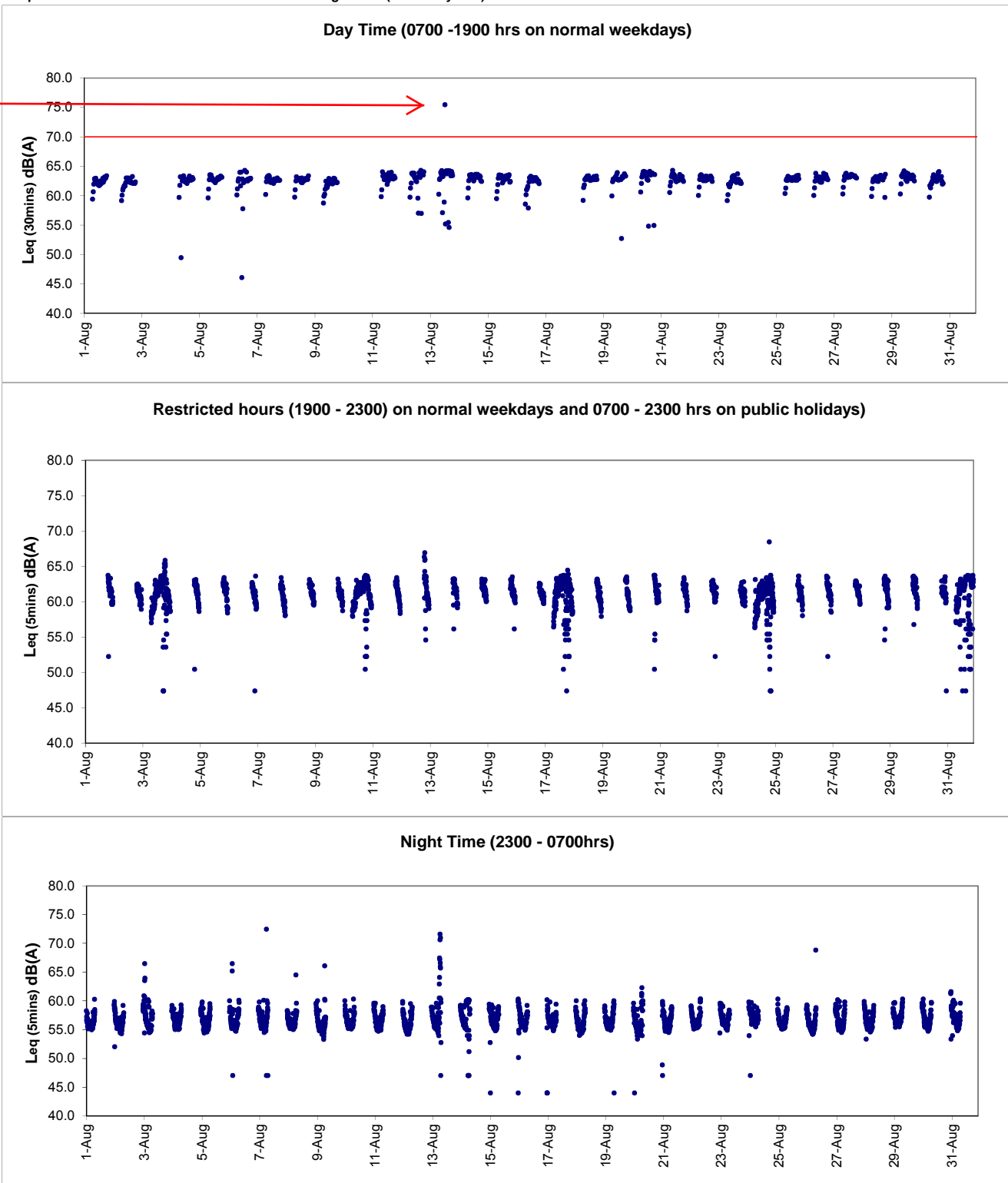

After checking with Contractor, no construction activity was conducted on 13 August 2014. In addition, thunderstorm warning for the concern location and red rainstorm warning were hoisting during the recorded period. As such, the exceedances were considered to be contributed by the adverse weather condition and not related to Project.



Appendix 5.3

Air Quality Monitoring Results and Graphical Presentations



Location: ACL1 - City Hall

Report on 24-hour TSP monitoring

Action Level ($\mu\text{g}/\text{m}^3$) - 163

Limit Level ($\mu\text{g}/\text{m}^3$) - 260

Date	Sampling Time	Weather Condition	Filter paper no.	Filter Weight, g		Elapse Time, hr		Sampling Time, hr	Flow Rate, m^3/min			Total Volume, m^3	TSP Level, $\mu\text{g}/\text{m}^3$
				Initial	Final	Initial	Final		Initial, Q_{si}	Final, Q_{sf}	Average		
4-Aug-14	14:25	Rainy	009414	2.8634	2.9408	3093.17	3117.17	24.00	1.27	1.28	1.28	1836	42
8-Aug-14	8:00	Fine	009562	2.8047	2.8748	3117.17	3141.17	24.00	1.27	1.28	1.27	1836	38
14-Aug-14	8:00	Rainy	009843	2.7607	2.8351	3144.17	3168.17	24.00	1.28	1.28	1.28	1844	40
20-Aug-14	8:00	Rainy	009839	2.7897	2.8328	3171.18	3195.18	24.00	1.15	1.28	1.22	1754	25
26-Aug-14	8:00	Fine	008541	2.8592	2.9285	3198.18	3222.18	24.00	1.32	1.32	1.32	1898	37

* Due to interruption of electricity supply, the 24hr TSP was rescheduled from 2 August 2014 to 4 August 2014

Report on 1-hour TSP monitoring

Action Level ($\mu\text{g}/\text{m}^3$) - 460

Limit Level ($\mu\text{g}/\text{m}^3$) - 500

Date	Sampling Time	Weather Condition	Filter paper no.	Filter Weight, g		Elapse Time, hr		Sampling Time, hr	Flow Rate, m^3/min			Total Volume, m^3	TSP Level, $\mu\text{g}/\text{m}^3$
				Initial	Final	Initial	Final		Initial, Q_{si}	Final, Q_{sf}	Average		
4-Aug-14	9:10	Rainy	009401	2.8547	2.8611	3090.17	3091.17	1.00	1.27	1.27	1.27	76	84
4-Aug-14	10:13	Rainy	009402	2.8490	2.8535	3091.17	3092.17	1.00	1.27	1.27	1.27	76	59
4-Aug-14	13:00	Rainy	009403	2.8477	2.8538	3092.17	3093.17	1.00	1.27	1.27	1.27	76	80
9-Aug-14	8:42	Fine	009844	2.7859	2.7892	3141.17	3142.17	1.00	1.28	1.28	1.28	77	43
9-Aug-14	9:47	Fine	009845	2.7791	2.7842	3142.17	3143.17	1.00	1.28	1.28	1.28	77	67
9-Aug-14	10:52	Fine	009846	2.7814	2.7848	3143.17	3144.17	1.00	1.28	1.28	1.28	77	44
15-Aug-14	8:46	Fine	009485	2.8515	2.8549	3168.17	3169.17	1.00	1.28	1.28	1.28	77	44
15-Aug-14	9:50	Fine	009336	2.8620	2.8660	3169.17	3170.17	1.00	1.28	1.28	1.28	77	52
15-Aug-14	10:54	Fine	009337	2.8634	2.8684	3170.17	3171.17	1.00	1.28	1.28	1.28	77	65
21-Aug-14	8:44	Rainy	009214	2.8534	2.8563	3195.18	3196.18	1.00	1.28	1.28	1.28	77	38
21-Aug-14	9:49	Rainy	009215	2.8531	2.8571	3196.18	3197.18	1.00	1.28	1.28	1.28	77	52
21-Aug-14	10:54	Rainy	009216	2.8431	2.8464	3197.18	3198.18	1.00	1.28	1.28	1.28	77	43
27-Aug-14	8:40	Cloudy	009827	2.7831	2.7910	3222.18	3223.18	1.00	1.32	1.32	1.32	79	100
27-Aug-14	10:20	Cloudy	009826	2.7811	2.7883	3223.18	3224.18	1.00	1.32	1.32	1.32	79	91
27-Aug-14	13:00	Cloudy	009825	2.7757	2.7815	3224.18	3225.18	1.00	1.32	1.32	1.32	79	73



Location: ACL2a - Contractor HK/2012/08 Site office

Report on 24-hour TSP monitoring

Action Level ($\mu\text{g}/\text{m}^3$) - 187.3

Limit Level ($\mu\text{g}/\text{m}^3$) - 260

Date	Sampling Time	Weather Condition	Filter paper no.	Filter Weight, g		Elapse Time, hr		Sampling Time, hr	Flow Rate, m^3/min			Total Volume, m^3	TSP Level, $\mu\text{g}/\text{m}^3$
				Initial	Final	Initial	Final		Initial, Q_{si}	Final, Q_{sf}	Average		
2-Aug-14	8:00	Rainy	009357	2.8488	2.9486	2222.85	2246.85	24.00	1.05	1.05	1.05	1514	66
8-Aug-14	8:00	Fine	009344	2.8517	2.9169	2249.85	2273.85	24.00	1.12	1.12	1.12	1612	40
14-Aug-14	8:00	Rainy	009543	2.8150	2.8947	2276.85	2300.85	24.00	1.10	1.10	1.10	1586	50
20-Aug-14	8:00	Rainy	009535	2.8250	2.9178	2303.86	2327.86	24.00	1.06	1.06	1.06	1527	61
26-Aug-14	8:00	Fine	009699	2.8602	3.0500	2330.86	2354.86	24.00	1.14	1.14	1.14	1642	116

Report on 1-hour TSP monitoring

Action Level ($\mu\text{g}/\text{m}^3$) - 300.1

Limit Level ($\mu\text{g}/\text{m}^3$) - 500

Date	Sampling Time	Weather Condition	Filter paper no.	Filter Weight, g		Elapse Time, hr		Sampling Time, hr	Flow Rate, m^3/min			Total Volume, m^3	TSP Level, $\mu\text{g}/\text{m}^3$
				Initial	Final	Initial	Final		Initial, Q_{si}	Final, Q_{sf}	Average		
4-Aug-14	13:00	Rainy	009421	2.8694	2.8750	2246.85	2247.85	1.00	1.05	1.05	1.05	63	89
4-Aug-14	14:34	Rainy	009445	2.8610	2.8658	2247.85	2248.85	1.00	1.05	1.05	1.05	63	76
4-Aug-14	15:40	Rainy	009259	2.8347	2.8408	2248.85	2249.85	1.00	1.05	1.05	1.05	63	97
9-Aug-14	8:52	Fine	009564	2.8153	2.8179	2273.85	2274.85	1.00	1.12	1.12	1.12	67	39
9-Aug-14	10:02	Fine	009555	2.8117	2.8145	2274.85	2275.85	1.00	1.01	1.10	1.05	63	44
9-Aug-14	13:00	Fine	009558	2.8172	2.8209	2275.85	2276.85	1.00	1.10	1.10	1.10	66	56
15-Aug-14	9:37	Fine	009546	2.8150	2.8181	2300.85	2301.85	1.00	1.10	1.10	1.10	66	47
15-Aug-14	13:00	Fine	009549	2.8235	2.8287	2301.85	2302.85	1.00	1.10	1.10	1.10	66	79
15-Aug-14	14:20	Fine	009552	2.8238	2.8289	2302.85	2303.85	1.00	1.10	1.10	1.10	66	77
21-Aug-14	8:10	Rainy	009691	2.8610	2.8690	2327.86	2328.86	1.00	1.10	1.10	1.10	66	121
21-Aug-14	9:17	Rainy	009693	2.8509	2.8599	2328.86	2329.86	1.00	1.10	1.10	1.10	66	136
21-Aug-14	10:28	Rainy	009696	2.8590	2.8663	2329.86	2330.86	1.00	1.10	1.10	1.10	66	110
27-Aug-14	9:20	Cloudy	009538	2.8202	2.8256	2354.88	2355.88	1.00	1.14	1.14	1.14	68	79
27-Aug-14	10:55	Cloudy	009591	2.8272	2.8371	2355.88	2356.88	1.00	1.10	1.10	1.10	66	150
27-Aug-14	13:00	Cloudy	009505	2.8420	2.8554	2356.88	2357.88	1.00	1.10	1.10	1.10	66	203



Graphic Presentation of 1 hour TSP Result

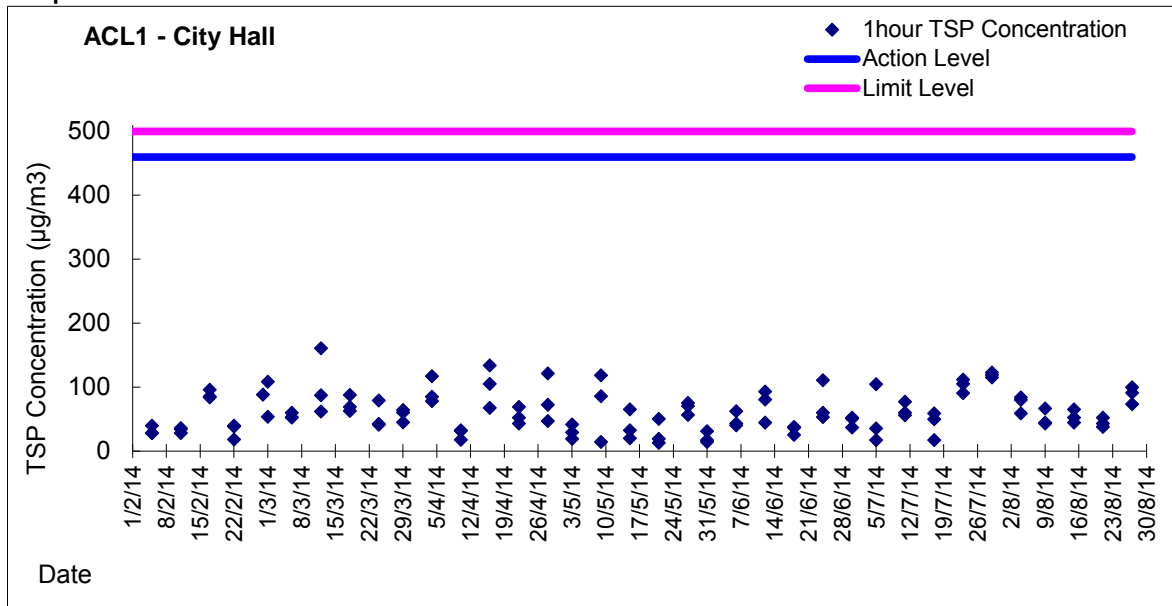

Graphic Presentation of 24 hour TSP Result

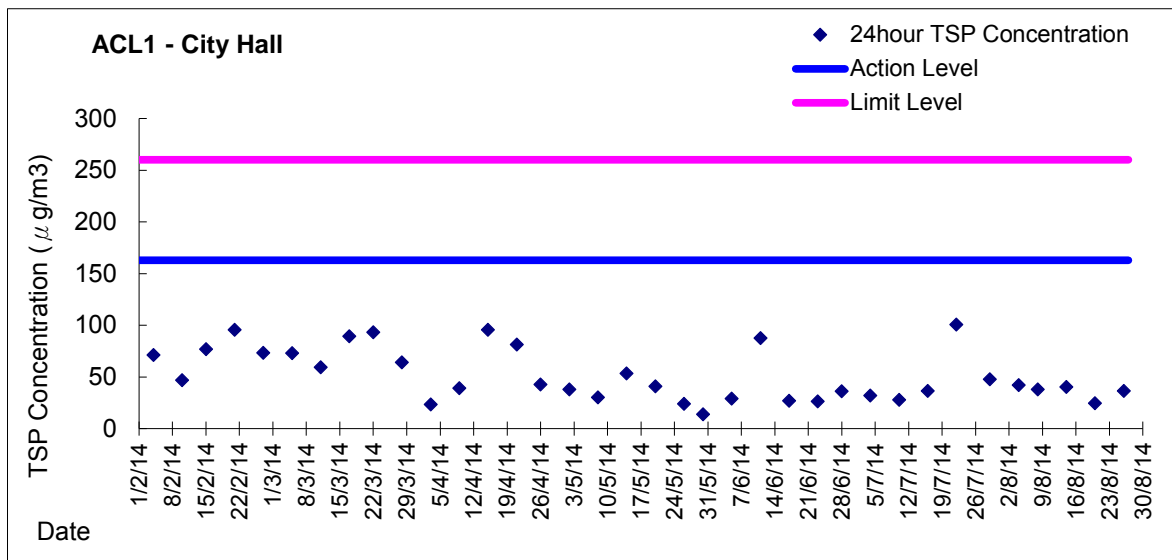



Graphic Presentation of 1 hour TSP Result

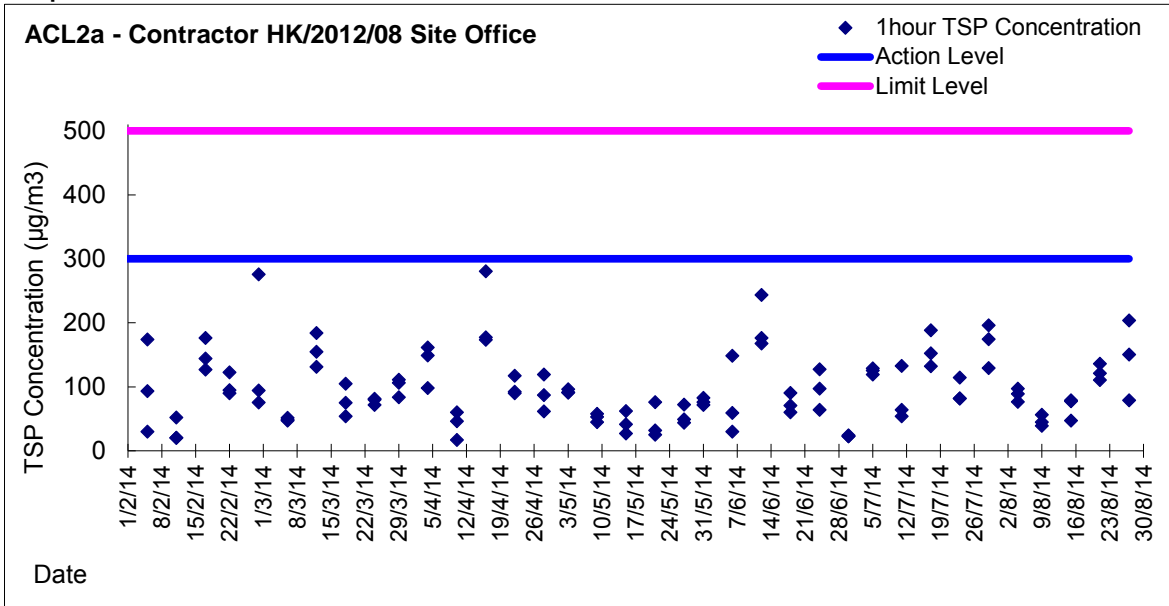

Graphic Presentation of 24 hour TSP Result

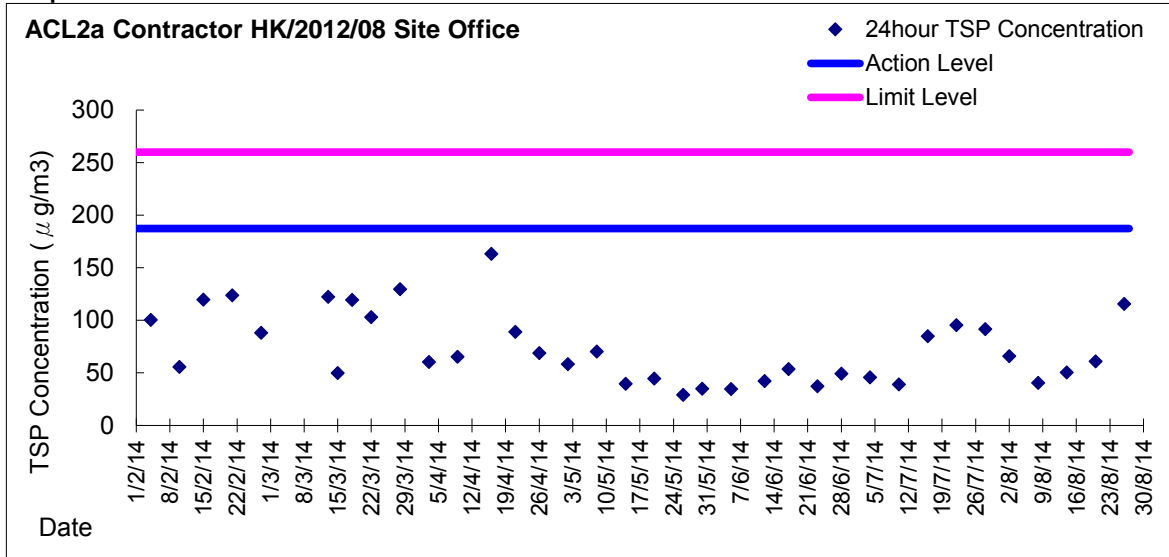



Appendix 6.1

Event Action Plans

Central Reclamation Phase III : Environmental Monitoring and Audit - Event and Action Plan for Air and Noise Quality

Event and Action Plan for Air Quality				
Event	Action			
	ET Leader	IC(E)	ER	Contractor
Action Level - Exceedance for one sample	<ol style="list-style-type: none"> 1. Identify source 2. Inform IC(E) and ER 3. Repeat measurement to confirm finding 4. Increase monitoring frequency to daily 	<ol style="list-style-type: none"> 1. Check monitoring data submitted by ET 2. Check Contractor's working method 	<ol style="list-style-type: none"> 1. Notify Contractor 	<ol style="list-style-type: none"> 1. Rectify any unacceptable practice 2. Amend working methods if appropriate
Action Level - Exceedance for two or more consecutive samples	<ol style="list-style-type: none"> 1. Identify source 2. Inform IC(E) and ER 3. Repeat measurement to confirm finding 4. Increase monitoring frequency to daily 5. Discuss with IC(E) and Contractor on remedial actions 6. If exceedance continues, arrange meeting with IC(E) and ER 7. If exceedance stops cease additional monitoring 	<ol style="list-style-type: none"> 1. Check monitoring data submitted by ET 2. Check Contractor's working method 3. Discuss with ET and Contractor on possible remedial measures 4. Advise the ER on the effectiveness of the proposed remedial measures 5. Supervise the implementation of remedial measures 	<ol style="list-style-type: none"> 1. Confirm receipt of notification of failure in writing 2. Notify Contractor 3. Ensure remedial measures properly implemented 	<ol style="list-style-type: none"> 1. Submit proposals for remedial actions to IC(E) within 3 working days of notification 2. Implement the agreed proposals 3. Amend proposal if appropriate
Limit Level - Exceedance for one sample	<ol style="list-style-type: none"> 1. Identify source 2. Inform ER and EPD 3. Repeat measurement to confirm findings 4. Increase monitoring frequency to daily 5. Assess effectiveness of Contractor's remedial actions and keep IC(E), EPD and ER informed of the results 	<ol style="list-style-type: none"> 1. Check monitoring data submitted by ET 2. Check Contractor's working method 3. Discuss with ET and Contractor on possible remedial measures 4. Advise the ER on the effectiveness of the proposed remedial measures 5. Supervise the implementation of remedial measures 	<ol style="list-style-type: none"> 1. Confirm receipt of notification of failure in writing 2. Notify Contractor 3. Ensure remedial measures properly implemented 	<ol style="list-style-type: none"> 1. Take immediate action to avoid further exceedance 2. Submit proposal for remedial actions to IC(E) within 3 working days of notification 3. Implement the agreed measures
Limit Level - Exceedance for two or more consecutive samples	<ol style="list-style-type: none"> 1. Notify IC(E), ER, Contractor and EPD 2. Identify source 3. Repeat measurements to confirm findings 4. Increase monitoring frequency to daily 5. Carry out analysis of Contractor's working procedures to determine possible mitigation to be implemented 6. Arrange meeting with IC(E) and ER to discuss the remedial actions to be taken 7. Assess effectiveness of Contractor's remedial actions and keep IC(E), EPD and ER informed of the results 8. If exceedance stops, cease additional monitoring 	<ol style="list-style-type: none"> 1. Discuss amongst ER, ET, and Contractor on the potential remedial actions 2. Review Contractor's remedial actions whenever necessary to assure their effectiveness and advise the ER accordingly 3. Supervise the implementation of remedial measures 	<ol style="list-style-type: none"> 1. Confirm receipt of notification of failure in writing 2. Notify Contractor 3. In consultation with the IC(E), agree with the Contractor on the remedial measures to be implemented 4. Ensure remedial measures properly implemented 5. If exceedance continues, consider what portion of the work is responsible and instruct the Contractor to stop that portion of work until the exceedance is abated 	<ol style="list-style-type: none"> 1. Take immediate action to avoid further exceedance 2. Submit proposals for remedial actions to IC(E) within 3 working days of notification 3. Implement the agreed proposals 4. Resubmit proposals if problem still not under control 5. Stop the relevant portion of works as determined by the ER until the exceedance is abated

Central Reclamation Phase III : Environmental Monitoring and Audit - Event and Action Plan for Air and Noise Quality

Event and Action Plan for Noise Quality				
Event	Action			
	ET Leader	IC(E)	ER	Contractor
Action Level is reached	<ol style="list-style-type: none"> 1. Notify IC(E) and Contractor 2. Carry out investigation 3. Report the results of the investigation to the IC(E) and Contractor 4. Discuss with the Contractor and formulate remedial measures 	<ol style="list-style-type: none"> 1. Discuss amongst ER, ET and Contractor on the potential remedial actions 2. Review Contractor's remedial actions whenever necessary to assure their effectiveness and advise the ER accordingly 3. Supervise the implementation of remedial measures 	<ol style="list-style-type: none"> 1. Confirm receipt of notification of failure in writing 2. Notify Contractor 3. Require Contractor to propose remedial measures for the analyzed noise problem 4. Ensure remedial measures are properly implemented 	<ol style="list-style-type: none"> 1. Submit noise mitigation proposal to IC(E) 2. Implement noise mitigation proposals
Limit Level is reached	<ol style="list-style-type: none"> 1. Notify IC(E), ER, EPD and Contractor 2. Identify source 3. Repeat measurement to confirm findings 4. Carry out analysis of Contractor's working procedures to determine possible mitigation to be implemented 5. Inform IC(E), ER and EPD the causes & actions taken for the exceedances 6. Assess effectiveness of Contractor's remedial actions and keep IC(E), EPD and ER informed of the results 7. If exceedance stops cease additional monitoring 	<ol style="list-style-type: none"> 1. Discuss amongst ER, ET and Contractor on the potential remedial actions 2. Review Contractor's remedial actions whenever necessary to assure their effectiveness and advise the ER accordingly 3. Supervise the implementation of remedial measures 	<ol style="list-style-type: none"> 1. Confirm receipt of notification of failure in writing 2. Notify Contractor 3. Require Contractor to propose remedial measures for the analyzed noise problem 4. Ensure remedial measures are properly implemented 5. If exceedance continues, consider what portion of the work is responsible and instruct the Contractor to stop that portion or work until the exceedance is abated 	<ol style="list-style-type: none"> 1. Take immediate action to avoid further exceedance 2. Submit proposals for remedial actions to IC(E) within 3 working days of notification 3. Implement the agreed proposals 4. Resubmit proposals if problem still not under control 5. Stop the relevant portion of works as determined by the ER until the exceedance is abated



Appendix 6.2

Summary for Notification of Exceedance



Ref no.	Date	Tidal	Location	Parameters (Unit)	Measured	Action Level	Limit Level	Follow-up action
--	--	--	--	--	--	--	--	--



Appendix 9.1

Complaint Log



Environmental Complaints Log

Complaint Log No.	Date of Complaint	Received From and Received By	Location of Complainant	Nature of Complaint	Outcome	Status
--	--	--	--	--	--	--



Appendix 10.1

Construction Programme of Individual Contracts



Activity ID	Activity Name	Orig Dur	Early Start	Early Finish	Total Float	2014			
						Jun	Jul	Aug	Sep
HK/2012/08 3-Mth Rolling Programme for Jun 2014 - Aug 2014 Rev. 1 on 24Jun14									
Dredging and Reclamation									
Marine Work Construction									
Dredging									
Dredging - Zone CRIII									
CRIII - Temporary Pipe Pile Wave Wall									
LPCU31020	CRIII - temp pipe pile wall (1-120) - Order Materials for 610 dia. pipe pile [120nos. @750c/c]	50	02-May-14 A	19-Jun-14	231				
MAR10028	CRIII - design of temporary pile wave wall - Eng comment and approve	28	20-Mar-14 A	26-Jun-14	63				
MAR12320	CRIII - temp pipe pile wall (35-70) - install 610 dia. pipe pile [30nos. @750c/c]	30	02-Jul-14	05-Aug-14	53				
MAR12340	CRIII - temp pipe pile wall (71-105) - install 610 dia. pipe pile [30nos. @750c/c]	30	28-Jul-14	30-Aug-14	53				
MAR12360	CRIII - temp pipe pile wall (91-120) - install 610 dia. pipe pile [30nos. @750c/c]	0	31-May-14	31-May-14	130				
Works for Section Completion									
Construction									
Section II A - CWB Tunnel & Slip Road Structures and Facilities									
CWB CRIII & A1									
CWB CRIII & A1 - Dwall and Pile Construction									
SIIA10620	Sec II A - CWB CRIII - predrilling for Dwall and piles	83	04-Dec-13 A	05-Aug-14	32				
SIIA10640	Sec II A - CWB CRIII - carry out ground pretreatment for Dwall	83	07-Feb-14 A	17-Jun-14	22				
SIIA10660	Sec II A - CWB CRIII - construct Guide Wall	40	10-Feb-14 A	16-Jun-14	23				
SIIA10680	Sec II A - CWB CRIII - construct DWall and barrette (1.2m thk on rock)	77	24-Feb-14 A	28-Jul-14	0				
SIIA10700	Sec II A - CWB CRIII - construct temporary DWall (1.2m thk)	60	29-Jul-14	09-Oct-14	0				
SIIA10710	Sec II A - CWB CRIII - Construct pre-bored H-pile	70	15-Aug-14	07-Nov-14	3				
SIIA10720	Sec II A - CWB CRIII - D-wall grout curtain / contact grout	85	01-Aug-14	11-Nov-14	0				
SIIA10740	Sec II A - CWB CRIII - D-wall Sonic test / interface core	85	01-Aug-14	11-Nov-14	0				
SIIA10760	Sec II A - CWB CRIII - install dewater/ recharge / observation well	85	01-Aug-14	11-Nov-14	0				

Data Date: 31-May-14

- Current Milestone
- Actual Work
- Critical Remaining Work
- Remaining Work
- Remaining Level of Effort

3 - Months Rolling Programme (June 2014 to August 2014)
For Zone CRIII Works

Date	Revision	Checked	Approved
31-May-14			